



2026 FOREST RIVER SALEM HEMISPHERE 310BHI

\$68,900.00

\$323 Bi-Weekly

SPECIFICATIONS

Year	2026
Manufacturer	FOREST RIVER
Brand	SALEM HEMISPHERE
Model	310BHI
Type	Travel Trailer
Status	New
Stock #	094945
Financing Available	✓
Warranty Available	✓
Suspension	N/A
Leveling	N/A
Exterior Length	36.8 ft.
Dry Weight	9582 lbs.
Sleeping Capacity	8 person(s)
Interior Colour	N/A
Exterior Colour	Fibreglass
Slideouts	3

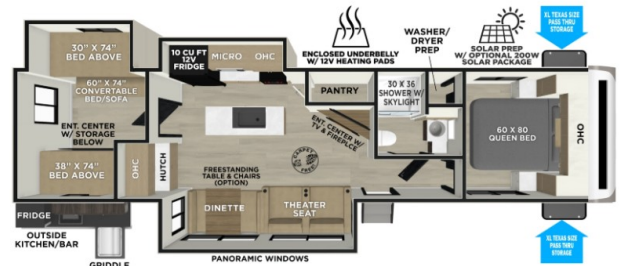

Disclaimer: Product information, pricing and photos are as accurate as possible and are subject to change without notice.

SELLING FEATURES

All new style 2026 Forest River Salem Hemisphere! Camp in comfort and luxury in this travel trailer!

Features:

- **ELEVATED PACKAGE:** WeatherShield One Piece Fiberglass Roof - Leading the Charge, Square Windows w/ Built in Shades w/ Reflective Thermal-Foil Backing w/ Painted Hardwood Interior Trim, Versa Tilt Power Bed Mechanism - Providing 14.5" of Additional Walk-Around Space, 60K BTU On-Demand Tankless Water Heater, 2" Accessory Hitch Receiver, Good Year Radial Tires w/ Black-Accented Aluminum Rims, Washer/Dryer prep
- **EXPEDITION PACKAGE:** 60" x 80" Beds in Master Bedrooms, Wide Stance Axles, 15K BTU Quiet Cool A/C on a Race Track Duct System, 50 Amp Service w/ Wiring & Brace for Second A/C, 30" Wide Black Glass Main Entry Door w/ Window Shade Prep, Enclosed Underbelly w/ 12V Tank Heaters on all Holding Tanks, 40" LED TV with Furrion Soundbar w/ FM, Bluetooth, HDMI & USB, Power Stabilizer & Tongue Jacks, (4) Storage Bins Included Under Bed
- **STANDARD FEATURES:** 10 cu.ft. Refrigerator (12V), Porcelain Toilet, Full Length Barreled Ceilings for Additional Head Room, Prepped for Roof-Mounted Solar Panel & Charge Controller, Wide Stance Axle System, Black Tank Flush, Side-Mounted Heat Ducts = No Floor Vents, Step Above Aluminum Steps (Main Entry Door), LP Quick Connect, Extra Large Pass Thru Storage w/ Slam Latch Baggage Doors, Yacht Trim Ceiling Finishes, Color-Matched T-Rail on Slide Outs for a Cleaner Aesthetic, Nordic Marble Countertops Throughout the Coach & Corresponding Frozen Nordic Backsplash, Wood Door Casings IPO Plastic Door Casings, Back Up Camera Prep, Matte Gold Cabinet Hardware, Power Tongue Jack w/ LED Docking Light, Residential Single Bowl Undermount Sink, LED Awning, Marker & Tail Lights, Theater Sofa, Undermount Spare Tire & Carrier, Outside Shower w/ Hot & Cold Water, Built In Laundry Hamper, 7-Way "Rain Defense" Plug Holder (Front Frame), Lippert On The Go Ladder Prep
- **SOLAR PACKAGE:** 200 Watt Roof Mounted Solar Package with 200W Panel, 30amp Charge Controller and a 12V Battery
- Sleeps up to 8- front queen bed, rear bunkroom that sleeps four, and a dinette that folds down to a bed
- Kitchen features 10cu ft fridge, range with oven, sink and lots of storage including a pantry
- Outdoor kitchen with bar fridge, sink, griddle and storage
- Bathroom with shower, toilet and vanity
- Includes filled propane tanks and deep cycle marine battery
- Full manufacturers warranty
- Dry weight of 9,582lbs

No hidden fees (freight, PDI, licensing, admin, or battery fee). Simply add the HST! Financing available.

OPTIONS & EQUIPMENT

- Pre-delivery Inspection
- Deep Cycle RV Battery
- Propane Tank(s)
- Licensing Completed
- Electrical Adaptor
- 25' Water Hose
- 10' Sewer Hose
- Thorough Walkthrough