



2026 FOREST RIVER SURVEYOR LEGEND 260BHLE

\$35,992.00

Originally \$54,066.75

SPECIFICATIONS

Year	2026
Manufacturer	FOREST RIVER
Brand	SURVEYOR LEGEND
Model	260BHLE
Type	Travel Trailer
Status	New
Stock #	TV479475
Financing Available	✓
Warranty Available	✓
Suspension	N/A
Leveling	N/A
Exterior Length	29.9 ft.
Dry Weight	5778 lbs.
Sleeping Capacity	6 person(s)
Interior Colour	N/A
Exterior Colour	Fiberglass
Slideouts	1

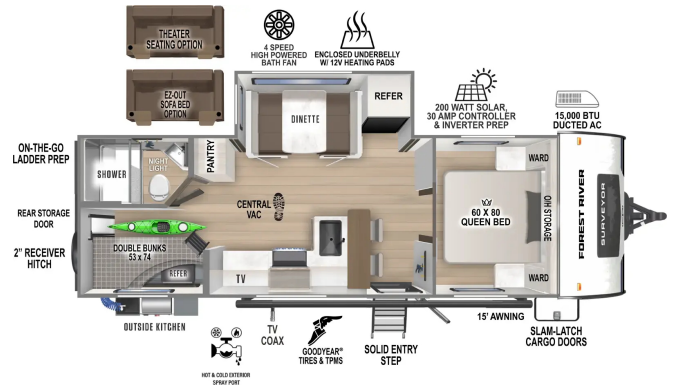

Disclaimer: Product information, pricing and photos are as accurate as possible and are subject to change without notice.

SELLING FEATURES

This 29' 11" travel trailer features a front private bedroom with a queen bed and dual wardrobes. The rear bunkhouse offers two oversized bunks and a wardrobe. The kitchen includes a 10 cu. ft. 12V refrigerator and stovetop. Living space includes a tri-fold sofa and a booth dinette. Exterior amen...

OPTIONS & EQUIPMENT

This 29' 11" travel trailer features a front private bedroom with a queen bed and dual wardrobes. The rear bunkhouse offers two oversized bunks and a wardrobe. The kitchen includes a 10 cu. ft. 12V refrigerator and stovetop. Living space includes a tri-fold sofa and a booth dinette. Exterior amenities include a 21' power awning with LED lights outdoor kitchen and a rear storage door.

Specifications and Features:

- Exterior Length (ft): 29'11"
- Exterior Width (ft): 8'0"
- Exterior Height (ft): 11'3"
- Gross Vehicle Weight Rating (GVWR) (lbs): 7 740
- Unloaded Weight (lbs): 5 778
- Payload Capacity (lbs): 1962
- Hitch Weight (lbs): 740
- Black Water Tanks: 1
- Total Black Water Capacity (gal): 30
- Grey Water Tanks: 1
- Total Grey Water Capacity (gal): 40
- Fresh Water Tanks: 1
- Total Fresh Water Capacity (gal): 40
- Propane Tanks: 2
- Total Propane Capacity (gal): 9.4
- Exterior: Aluminum
- Slideouts: 1
- Awnings: 1
- Sleeps up to: 6
- Queen Beds: 1
- Bunk Beds: 2
- Sofa/Convertible Beds: 1
- Oven Burners: 3
- Air Conditioning (A/C) (btu): 15 000
- Water Heater Pump Power Mode: Electrical / Propane

Surveyor Turn Key Package:

- Extended Season Ready
- 2" Aluminum Framed Floor w/ Block Foam Insulation
- Sealed Underbelly w/ Forced Heat & Radiant Foil Insulation
- 12V Tank Heaters
- Goodyear® Tires
- Automotive Style Tinted Front Windshield
- 200 Watt Solar Panel & 30 Amp Solar Controller
- Solar Inverter Prep
- Tire Pressure Monitoring System (TPMS)
- Electric Awning w/ LED Lightstrip
- Central Vac System
- 10 Cu. Ft. 12V Black Glass Refrigerator
- Adjustable Platform Entry Step w/ Night Light (All Entries)
- 2" Rear Accessory Hitch
- Tankless Water Heater
- Roller Shades T/O
- Upgraded Slow-Close Shower Door
- HD TV
- Surf(X)® Seamless Countertops T/O
- 21" Oven (N/A Sub 4 Series)
- 4 Speed Bath Fan
- Aluminum Wheels
- Slam Latch Exterior Baggage Doors
- Outdoor Kitchen
- Hot & Cold Exterior Spray Port
- Power Tongue Jack w/ Hitch Light
- Roof Ladder Prep
- Rear Camera Prep

Powered by focusRV