



WOODY'S RV WORLD ABBOTSFORD

webleads@woodysrvworldabbotsford.dsmessage.com 1-844-854-1288

31708 Marshall Road, Abbotsford, BC V2T 6B1

Local 1-604-854-1288 | Fax 1-604-854-1406 | https://www.woodysrv.com/



2026 COACHMEN APEX 228BH5

MSRP \$64,980.00

\$216 Bi-Weekly

\$0 down @ 7.99% APR for 60/240 months

(\$21,072 C.O.B.) O.A.C.

Woody's Price \$49,980.00

SPECIFICATIONS

Year	2026
Manufacturer	COACHMEN
Brand	APEX
Model	228BH5
Type	Travel Trailer
Status	New
Stock #	51709
Financing Available	✓
Warranty Available	Manufacturer
Suspension	N/A
Leveling	N/A
Exterior Length	27.7 ft.
Dry Weight	4632 lbs.
Sleeping Capacity	7 person(s)
Interior Colour	N/A
Exterior Colour	Fiberglass
Slideouts	1

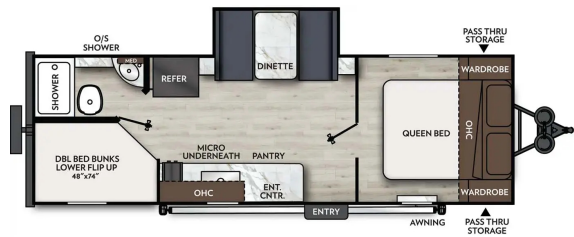

Disclaimer: Product information, pricing and photos are as accurate as possible and are subject to change without notice.

SELLING FEATURES

Specifications and Features:

- Exterior Height: 10' 2"
- Exterior Width: 7' 6"
- Cargo Carrying Capacity: 1,368 lbs
- Number of Bunks: 2
- Available Beds: Queen
- Refrigerator Type: 12V
- Refrigerator Size: 10 cu ft
- Cooktop Burners: 2
- Number of Awnings: 1
- LP Tank Capacity: 20 lbs
- Wate...

OPTIONS & EQUIPMENT

- SORRENTO DECOR
- APEX NANO PACKAGE
- COMFORT PACKAGE
- OFF GRID PACKAGE
- 12 VOLT HEAT PADS FOR BLACK, GREY AND FRESH WATER
- 15" ALL TERRAIN TIRES W/ ALUM RIMS
- QAI CANDIAN COMPLIANCE
- MVSA SEAL
- RVIA SEAL
- DEALER PICKUP
- SORRENTO CABINETRY
- SHAKER CABINET DOOR FRAMES W/ MAGNETIC CATCHES
- ONE PIECE SEAMLESS EDGE COUNTERTOPS
- CONGOLEUM RESIDENTIAL STYLE FLOORING
- OVERHEAD BEDROOM CABINETS W/ SIDE WARDROBES AND REMOVABLE SHELF
- HARD VALANCES W/ ROLLER SHADES
- PEDESTAL DINETTE TABLE
- BOOTH DINETTE
- LP LEAK ALARM
- FIRE EXTINGUISHER
- SMOKE ALARM
- CARBON MONOXIDE DETECTOR
- LED INTERIOR LIGHTING

- HIGH VELOCITY 10" POWER ROOF VENT
- MOUNTED PREMIUM ALPINE BLUETOOTH WIRELESS SPEAKER
- MATTRESS W/ COVER
- MAGNETIC CABINET DOOR CATCHES
- ACCESS DOORS UNDER DINETTE
- APEX THROW BLANKET
- DIRECT VENT FURNACE
- 15,000 BTU AIR CONDITIONING
- 8000 BTU A/C
- 55AMP POWER CENTER
- 40-WATT SOLAR SYSTEM W/ 30 AMP CONTROL CHARGER
- OUTSIDE RECEPTACLE GFI
- DETACHABLE MARINE STYLE POWER CORD
- 12V OUTLETS
- USB/USBC CHARGERS
- INVERTER PREP
- 10CUFT 12V FRIDGE
- NARROW FLUSH MOUNT 2 BURNER COOKTOP
- AIRFRYER MICROWAVE
- STAINLESS STEEL SINGLE BOWL SINK W/ FLUSH MOUNT COVER
- ONE PIECE SEAMLESS EDGE COUNTERTOPS
- MATTE BLACK HARDWARE
- ON DEMAND TANKLESS WATER HEATER 48,000BTU
- POWER BATH VENT
- WATER HEATER BYPASS VALVE
- ON DEMAND WATER PUMP
- BELOW FLOOR LOW POINT DRAINS
- FOOT FLUSH TOILET
- SHOWER / TUB SURROUND
- SKYLIGHT IN BATH
- HOT / COLD OUTSIDE SHOWER
- BLACK TANK FLUSH
- 52-GALLON FRESH WATER TANK
- SWING AWAY ASSIST HANDLE
- FIBERGLASS FRONT CAP W/ WINDSHEILD
- HEATED AND ENCLOSED UNDERBELLY W/ FORCED AIR
- GUTTER RAIL
- POWER AWNING W/ LED LIGHTS
- 20LB LP TANKS W/ COVER
- DUAL BATTERY TRAY
- SOLID STEP
- TINTED SAFETY GLASS RADIUS WINDOWS
- RADIUS GLASS FRICTION HINGE ENTRANCE DOOR
- DEADBOLT LOCK
- RADIUS THUMB LATCH BAGGAGE DOORS
- BREAK AWAY SWITCH
- BACKUP CAMERA PREP
- BATTERY DISCONNECT
- FRAME RECEIVER PREP
- REGULATED LP PORT
- LADDER PREP
- SPARE TIRE AND CARRIER
- STABILIZER JACKS
- STARLINK PREP

Powered by focusRV