



## RECREATION WORLD RV

sales@recworldrv.com 1-807-767-3455

2320 Dawson Rd, Thunder Bay, ON P7G 2G2

Local 1-807-767-3455 | Fax 1-807-767-4803 | <https://www.recworldrv.com/>



## 2026 CHEROKEE GREY WOLF 22 MKSE

### SPECIFICATIONS

Year	2026
Manufacturer	CHEROKEE
Brand	GREY WOLF
Model	22 MKSE
Type	Travel Trailer
Status	New
Stock #	TV2707
Financing Available	✓
Warranty Available	✓
Suspension	N/A
Leveling	N/A
Exterior Length	26.9 ft.
Dry Weight	4341 lbs.
Sleeping Capacity	7 person(s)
Interior Colour	N/A
Exterior Colour	N/A
Slideouts	N/A

**Disclaimer:** Product information, pricing and photos are as accurate as possible and are subject to change without notice.

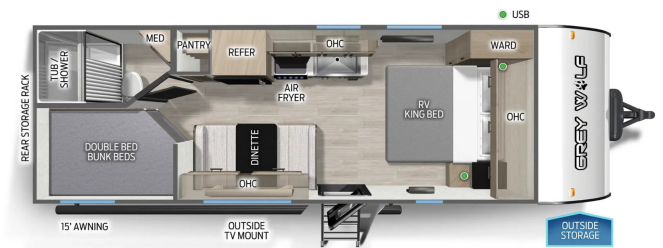
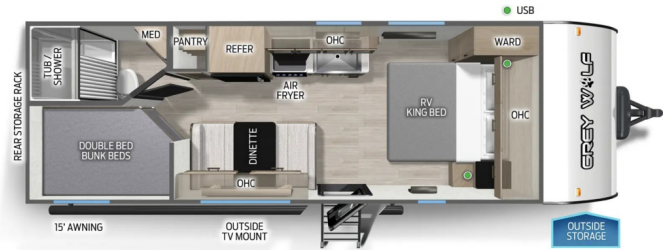

### SELLING FEATURES

The Grey Wolf 22MKSE by Forest River is a compact and versatile travel trailer, perfect for families. The innovative Cherokee Sleep System bed transforms from a sofa into a queen-size bed, maximizing space and flexibility. The rear bunkhouse provides additional sleeping space for kids or guests. ...

### OPTIONS & EQUIPMENT

- Exterior

#### Functional

- 12-volt Tank Heaters (N/A on LP models)
- 15.0K BTU Air Conditioner
- 20 000 BTU Furnace
- 55 Amp Converter
- 200W Solar Panel 40 Amp Charge Controller Voltmeter & Battery Disconnect (N/A on LP models)
- Backup Camera System (N/A on LP models)
- Black Tank Flush Out Kit (N/A on LP models)
- Carbon Monoxide Detector
- Detachable Power Cord
- Emergency Exit Windows
- Exterior 11V Receptacle
- Exterior LED Light Strip at Awning (N/A on LP models)
- GFI Protective Outlet
- High Flo Water Pump
- Inside and Outside Speakers (N/A on LP models)
- LP Gas Detector
- Monitor Panel for Tanks and Battery Levels
- Power Gear Frame Technology and Space Saver Rail Design
- Roadside Assistance
- Safety Glass Windows
- Smoke Detector
- Tankless Water Heater (N/A on LP models)
- Tire Pressure Indicators
- Tongue and Groove Plywood Flooring (5/8")
- External Scare Light
- Fire Extinguisher

