



SPECIAL UNIT

\$124,900.00

Originally \$129,900

\$581 Bi-Weekly

2026 ELEVATION PARK MODEL 5-113CA

SPECIFICATIONS

Year	2026
Manufacturer	ELEVATION
Brand	PARK MODEL
Model	5-113CA
Type	Park Model
Status	New
Stock #	683201
Financing Available	✓
Warranty Available	✓
Suspension	N/A
Leveling	N/A
Exterior Length	36.0 ft.
Dry Weight	19000 lbs.
Sleeping Capacity	8 person(s)
Interior Colour	N/A
Exterior Colour	Vinyl Siding
Slideouts	N/A

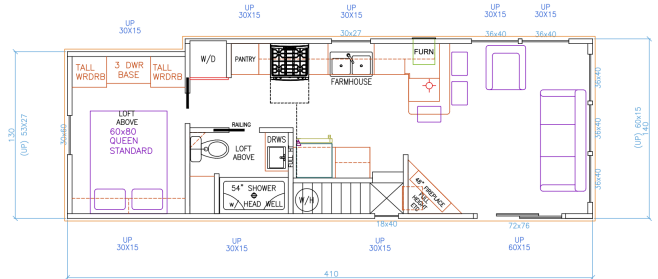

Disclaimer: Product information, pricing and photos are as accurate as possible and are subject to change without notice.

2x4 SIDEWALLS W/ ZIP-R

DEALER / CUSTOMER	SMITHVILLE RV - STOCK	DATE	10/2/2025
UNIT DESIGNATION	5-113CAR P09 2105 12'x37'	REV	00 / 00 / A

ELEVATION

SELLING FEATURES

Light, bright park model- just arrived!

- Sleeps up to 8- rear queen bedroom with a spacious
- Kitchen includes residential fridge and stove, microwave, lots of cabinets and large sink
- Pantry
- Spacious living room complete with couch, chair and end table
- Entertainment space with TV and fireplace
- Bathroom with stand up shower, vanity, toilet, and lots of storage
- Washer/Dryer
- Sliding Patio Door entry with internal blinds (between the glass)
- Manufacturers warranty
- Delivery and set up available!

Construction:

- Architectural Shingles - 40 Year Warranty
- 7/16" OSB Roof Decking w/ Ice & Weather shield
- 2x6 Perimeter Fascia
- Engineered Truss Rafters 16" o.c.
- Fixed Side Overhangs
- Vinyl Siding w/50 Year Warranty
- Fiberglass Insulation: R-11 Sidewalls, R-22 Floors, & R-33 Roof
- Weather resistant Thermo-Sheathing
- Metal Strapping Connecting Sidewalls to Floor
- 2x4 Sidewall Studs 16" o.c.
- 10" Steel I-Beam Frame w/ 4 axles
- 2x6 Floor joists 16" o.c.
- Floor ductwork w/ perimeter registers
- 5/8" Decking w/ water sealant
- 6' Vinyl Patio Door

- Vinyl Thermopane Windows w/ Argon
- Shed Dormers Entire Length
- Removable CSA Hitch
- Metal Hurricane Straps

Standard Features:

- 50 Amp Electrical cord (36')
- Central Air
- 30-gallon electric W/H w/ lighted switch
- 18' GE Refrigerator w/ top freezer - Black
- 30" GE Gas Range
- 30" Over the Range Microwave
- Stainless Steel Deep Kitchen Sink
- Pull down spray kitchen faucet
- Kitchen Peninsula with swivel stools
- Black or Brushed Nickel hardware
- Custom high-end residential cabinetry
- Baseboard Moulding throughout
- Toe Kicks in Cabinetry, Cabinet Crown Moulding
- Raised Panel Interior Doors
- Cordless 2" Blinds
- LED can lights throughout
- 60 x 80 Standard Queen premium mattress
- 2 Night Stands in Bedroom
- Master BRM hanging wardrobe w/ drawer bank
- Hide a bed sofa
- Fiberglass Shower w/ fiberglass headwell
- Single Lever Bathroom Faucet
- Stainless Steel Bathroom Sink
- Residential House Toilet
- Power bathroom vent
- TV Jack in LR, BRM & Loft
- USB outlets in Kitchen, Bedroom, & Loft
- Porch Lights by Each Door
- Exterior 110 GFI outlet
- Fire Extinguisher
- Smoke & CO2 Detector

Upgraded Options:

- 56,000 BTU furnace
- Woodgrain ceiling
- Fireplace feature wall
- Farmhouse sink
- Washer/Dryer
- Lift up Bed Box
- Queen hide a bed sofa
- Galvanized Metal Underbelly
- Smart TV

No hidden fees (freight, PDI, licensing, admin, or battery fee). Simply add the HST!

Financing available.

OPTIONS & EQUIPMENT

- Pre-delivery Inspection
- Thorough Walkthrough

Powered by focusRV