



## CAPITAL RECREATION

roman@capitalrv.ca 1-613-529-1133  
3201 County Rd 2, Johnstown, ON K0E 1T1  
Local 1-613-529-1133 | <https://www.capitalrecreation.ca/>



## 2026 COACHMEN CLIPPER 6K SERIES 22BHSR

**\$34,999.00**

Originally \$44,999.00

### SPECIFICATIONS

Year	2026
Manufacturer	COACHMEN
Brand	CLIPPER 6K SERIES
Model	22BHSR
Type	Travel Trailer
Status	New
Stock #	NZJCTW22BHSR26
Financing Available	✗
Warranty Available	✗
Suspension	N/A
Leveling	N/A
Exterior Length	26.0 ft.
Dry Weight	5498 lbs.
Sleeping Capacity	6 person(s)
Interior Colour	N/A
Exterior Colour	N/A
Slideouts	2

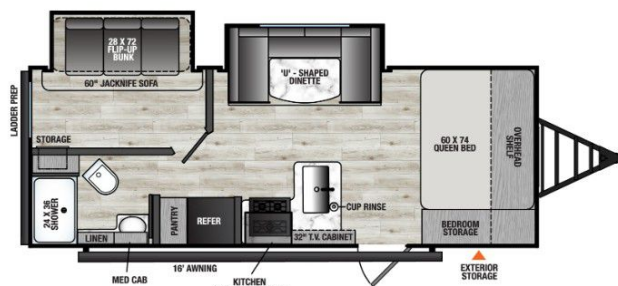

**Disclaimer:** Product information, pricing and photos are as accurate as possible and are subject to change without notice.

### SELLING FEATURES

Specifications and Features:

- Exterior Width: 8 ft
- Exterior Height: 11 ft
- Cargo Capacity: 2,102 lbs
- Furnace: 30,000 BTU
- Available Beds: RV Queen
- Refrigerator Type: 12 Volt
- Refrigerator Size: 10 cu ft
- Cooktop Burners: 3
- Shower Size: 24" x 36"
- Number of Awnings: 1
- Water Hea...

### OPTIONS & EQUIPMENT

- Quality & Appliance Package: 10 Cu. Ft. GE 12V Refrigerator 13.5K GE Roof-Mounted A/C Stainless GE Microwave Stainless GE 3-Burner Cooktop with Range Vent 30K BTU Furnace Tankless On-Demand Water Heater Electric Brakes Easy Lube Axles BAL NXG Frame with Supreme Powder Coating & HUCK Bolt Assembly 5/8" Tongue and Groove Plywood Flooring Drop Edge Thermofoil Countertops Seamless One-Piece TPO Roof Membrane
- Camping Made Easy Package: Solid Entry Steps Black Tank Flush Battery Disconnect Large Entrance Grab Handle Outside Shower Foot Flush Toilet Back-up Camera Prep Magnetic Baggage Door Latches Power Awning w/ LED Strip and Adjustable Legs Smooth Metal Front Solar Prep USB Charging Ports Cable TV Hook-Up

Powered by focusRV