



2026 ELEVATION PARK MODEL 7-114CA

\$179,900.00

\$838 Bi-Weekly

SPECIFICATIONS

Year	2026
Manufacturer	ELEVATION
Brand	PARK MODEL
Model	7-114CA
Type	Park Model
Status	New
Stock #	683162
Financing Available	✓
Warranty Available	✓
Suspension	N/A
Leveling	N/A
Exterior Length	45.0 ft.
Dry Weight	19000 lbs.
Sleeping Capacity	6 person(s)
Interior Colour	N/A
Exterior Colour	Vinyl Siding
Slideouts	N/A

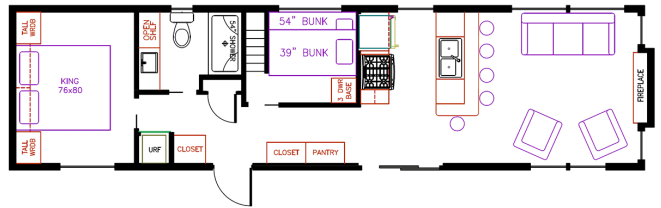

Disclaimer: Product information, pricing and photos are as accurate as possible and are subject to change without notice.

SELLING FEATURES

Luxurious, Light, bright park model - JUST ARRIVED!

- Sleeps up to 6 - rear king bedroom, separate bunk-room with single over double bunks and pull out couch in living area
- Kitchen includes residential fridge and stove, microwave, lots of cabinets and large sink
- Pantry
- Spacious living room complete with couch
- Entertainment space with TV, fireplace and ceiling fan
- Bathroom with stand up shower, vanity, toilet, and lots of storage
- Washer/Dryer prep
- Two door entrance and entrance way closet as well as two additional closets
- Manufacturers warranty
- Delivery and set up available!

Construction:

- Standing seam metal roof
- Anderson 100 Series Vinyl Windows (Black or White)
- 7/16" OSB Roof Decking w/ Ice & Weather shield
- 2x6 Perimeter Fascia
- Engineered Truss Rafters 16" o.c.
- 7' Sidewalls w/ Cathedral Ceiling
- Fixed Side Overhangs
- Metal Underbelly
- Premium color Vinyl Siding w/ 50 Year Warranty
- Vinyl Shakes or Board & Batten - Front end & Dormers
- Fiberglass Insulation: R-22 Sidewalls, R-22 Floors, & R-33 Roof
- Zip systems OSB w/ built in vapor barrier
- Metal Strapping Connecting Sidewalls to Floor
- 2x4 Sidewall Studs 16" o.c.
- 10" Steel I-Beam Frame
- 2x6 Floor joists 16" o.c.
- Floor ductwork w/ perimeter registers
- 5/8" Decking w/ water sealant
- 6' Vinyl Patio Door w/ Built in Blinds
- Shed Dormers Entire Length
- Removable Hitch
- Metal Hurricane Straps

Standard Features:

- 50 Amp Electrical cord (36')
- Prep for Central Air
- 20-gallon electric W/H w/ lighted switch
- GE Appliance package w/ 22' French door or Side by Side refrigerator, 30" Over the Range Microwave, & 30" Gas Range - (Black, Stainless Steel, or Slate)
- Kohler Industrial kitchen faucet w/ pull down sprayer

- Island w/ Bar Stools
- Kitchen Island Pendant Lights
- LED lights under Kitchen Cabinets
- Plywood construction Custom high-end staggered cabinetry w/ Slow-close cabinet doors & drawers, 5-piece drawer fronts
- Real Hardwood trim package including: Cabinet crown, ceiling crown, Baseboard molding, window & door trim, & under Cabinet trim.
- Toe Kicks in Cabinetry
- Solid Surface countertops throughout
- Stone backsplash
- Raised Panel Solid core Interior Doors
- Cordless 2" Blinds
- LED can lights throughout
- Can lights in front overhang
- Ceiling Fan w/Light
- Serta 60 x 80 Standard Queen premium mattress
- Lift up bed box
- 2 Night Stands in Bedroom
- Master BRM hanging wardrobe w/ drawer bank
- Full height Entertainment center w/ Fireplace & wood mantle
- Wood feature material on ETC & in Bedroom
- Queen Hide a bed sofa
- 60" Shower w/ Deluxe glass door & 2 head rain system
- Single Lever Bathroom Faucet
- Stainless Steel Bathroom Sink
- Kohler Residential Elongated Comfort Height Toilet
- Power bathroom vent
- 55" LG Smart TV in Living room, 43" LG Smart TV in bedroom
- USB outlets in Kitchen, Bedroom
- Porch Lights by Each Door
- Exterior 110 GFI outlet
- Fire Extinguisher
- Smoke & CO2 Detector

Upgraded Features:

- CSA Seal
- Ceiling: Rustic White Oak w/Etch Wood Beam
- Bench & OHC w/Coat Hooks & Live Edge Top in Hall
- A/C - Park Pak - Shipped Loose
- Furnace 56,000BTU
- Washer and Dryer - 110V Anderson 100 Series Window Pkg - White/White
- 2'x4' Walls w/2' ZIP-R System OSB Entire Unit
- Sofa Style: La-Z-Boy
- Dishwasher - 24"

No hidden fees (freight, PDI, licensing, admin, or battery fee). Simply add the HST!

Financing available.

OPTIONS & EQUIPMENT

- Pre-delivery Inspection
- Thorough Walkthrough