



WOODY'S RV WORLD ABBOTSFORD

webleads@woodysrvworldabbotsford.dsmessage.com 1-844-854-1288

31708 Marshall Road, Abbotsford, BC V2T 6B1

Local 1-604-854-1288 | Fax 1-604-854-1406 | <https://www.woodysrv.com/>



2026 COACHMEN APEX NANO 190RBS

MSRP \$54,980.00

\$194 Bi-Weekly

\$0 down @ 7.99% APR for 60/240 months

(\$18,964 C.O.B.) O.A.C.

Woody's Price \$44,980.00

SPECIFICATIONS

Year	2026
Manufacturer	COACHMEN
Brand	APEX NANO
Model	190RBS
Type	Travel Trailer
Status	New
Stock #	51493
Financing Available	✓
Warranty Available	Manufacturer
Suspension	N/A
Leveling	N/A
Exterior Length	22.6 ft.
Dry Weight	3670 lbs.
Sleeping Capacity	3 person(s)
Interior Colour	N/A
Exterior Colour	Aluma-Cage Construction
Slideouts	1

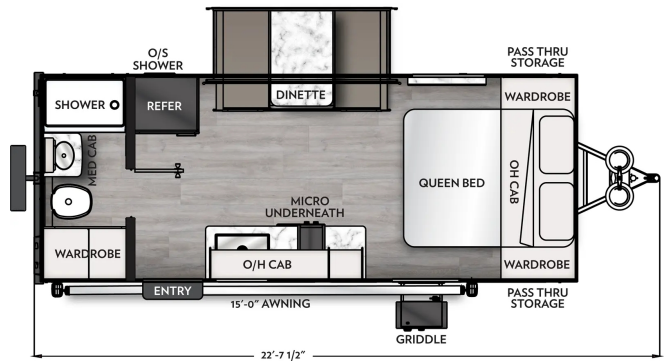

Disclaimer: Product information, pricing and photos are as accurate as possible and are subject to change without notice.

SELLING FEATURES

Specifications and Features:

- Exterior Height: 10' 2"
- Exterior Width: 7' 6"
- Cargo Capacity: 1,030 lbs
- Number of Awnings: 1
- Awning Size: 15 ft
- Refrigerator: 10 Cu. Ft. 12V
- Cooktop Burners: 2
- Water Heater: On Demand Tankless (48,000 BTU)
- Air Conditioner: 15,000 BTU
- Furnace: D...

OPTIONS & EQUIPMENT

- SORRENTO CABINERY
- SHAKER CABINET DOOR FRAMES W/ MAGNETIC CATCHES
- ONE-PIECE SEAMLESS EDGE COUNTERTOPS
- CONGOLEUM RESIDENTIAL-STYLE FLOORING
- OVERHEAD BEDROOM CABINETS W/ SIDE WARDROBES / REMOVABLE SHELF
- HARD VALANCES W/ ROLLER SHADES
- PEDESTAL DINETTE TABLE
- BOOTH DINETTE
- LP LEAK ALARM
- FIRE EXTINGUISHER
- SMOKE ALARM
- CARBON MONOXIDE DETECTOR
- LED INTERIOR LIGHTING
- HIGH VELOCITY 10" POWER ROOF VENT
- MOUNTED PREMIUM ALPINE BLUETOOTH WIRELESS SPEAKER
- MATTRESS W/ COVER
- MAGNETIC CABINET DOOR CATCHES
- ACCESS DOORS UNDER DINETTE
- APEX THROW BLANKET
- DIRECT VENT FURNACE
- 15,000 BTU AIR CONDITIONING
- 55AMP POWER CENTER
- 400WATT SOLAR SYSTEM W/ 30AMP CONTROL CHARGER

- OUTSIDE RECEPTACLE GFI
- DETACHABLE MARINE STYLE POWER CORD
- 12V OUTLETS (PASS-THRU)
- USB/USBC CHARGERS
- INVERTER PREP
- 10 CU.FT 12V FRIDGE
- NARROW FLUSH-MOUNT 2 BURNER COOKTOP
- AIRFRYER MICROWAVE
- STAINLESS STEEL SINGLE BOWL SINK W/ FLUSH MOUNT COVER
- ONE-PIECE SEAMLESS EDGE COUNTERTOPS
- MATTE BLACK HARDWARE
- ON DEMAND TANKLESS WATER HEATER 48,000 BTU
- POWER BATH VENT
- WATER HEATER BYPASS VALVE
- ON-DEMAND WATER PUMP
- BELOW FLOOR LOW POINT DRAINS
- FOOT FLUSH TOILET
- SHOWER/TUB SURROUND
- SKYLIGHT IN BATH
- HOT/COLD OUTSIDE SHOWER
- BLACK TANK FLUSH
- 52-GALLON FRESH WATER TANK
- ALUMA-CAGE CONSTRUCTION
- LAMINATED ALUMINUM FRAMED FLOOR
- CORROSION RESISTANT POWER COATED FRAME
- I-BEAM CHASSIS CONSTRUCTION
- SWING AWAY ASSIST HANDLE
- FIBERGLASS FRONT CAP W/ WINDSHIELD
- GUTTER RAIL
- POWER AWNING W/ LED LIGHT
- 20LB LP TANKS W/ COVER
- DUAL BATTERY TRAY
- SOLID STEP
- TINTED SAFETY GLASS RADIUS WINDOWS
- RADIUS GLASS FRICTION HINGE ENTRANCE DOORS
- BREAK AWAY SWITCH
- BACK-UP CAMERA PREP
- BATTERY DISCONNECT
- REGULATED LP PORT
- LADDER PREP
- SPARE TIRE AND CARRIER
- STABILIZER JACKS
- STARLINK PREP

Powered by focusRV