

NIAGARA TRAILERS

rving@niagaratrailers.com 1-800-348-9653
Box 153 1224 York Road, St Davids, ON L0S 1P0
Local 1-905-262-4518 | Fax 1-905-262-4697 | www.niagaratrailers.com



SPECIAL UNIT

\$59,900.00

Originally \$67,900

\$315 Bi-Weekly

2026 EAST TO WEST ALTA 2850KRL

SPECIFICATIONS

| | |
|---------------------|-----------------|
| Year | 2026 |
| Manufacturer | EAST TO WEST |
| Brand | ALTA |
| Model | 2850KRL |
| Type | Travel Trailer |
| Status | New |
| Stock # | FR1810 |
| Financing Available | ✓ |
| Warranty Available | ✓ |
| Suspension | N/A |
| Leveling | N/A |
| Exterior Length | 33.0 ft. |
| Dry Weight | 6812 lbs. |
| Sleeping Capacity | 6 person(s) |
| Interior Colour | WESTFIELD LATTE |
| Exterior Colour | N/A |
| Slideouts | 1 |

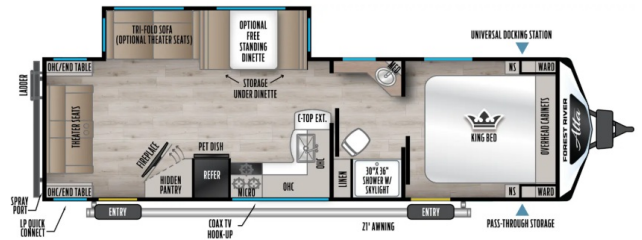

Disclaimer: Product information, pricing and photos are as accurate as possible and are subject to change without notice.

SELLING FEATURES

LUXE DÉCOR PACKAGE

- 81" Interior ceiling height
- 10.7 cubic foot 12 volt black glass residential-inspired refrigerator
- 3-Burner range w/ oven
- Solid bedroom door where available
- Cable/satellite ready
- USB charging stations (beds, bunks & tables where available)
- Sink cover
- Theater ...

OPTIONS & EQUIPMENT

INCLUDED OPTIONS:

- Goodyear Tires
- Ladder
- Spare Tire & Carrier
- 50" LED Smart TV
- West Coast Power Package (Upgraded 200 Watt Panels 30 Amp Controller)
- 50 Amp Service w/2nd A/C Prep
- 5 Point Auto Level
- 200 Watt Solar Pkg/ w/30 Amp Controller & Battery
- Solid Step Entry

ALSO INCLUDES:

- Pre-delivery Inspection
- 10' Sewer Hose with adapter
- Deep Cycle RV Battery
- Propane Tank(s)
- Electrical Adapter
- 25' Water Hose
- RVIA/QAI/Canadian Standard