



2026 FOREST RIVER ROCKWOOD MINI LITE 2205S

\$38,992.00

Originally \$55,538.00

SPECIFICATIONS

Year	2026
Manufacturer	FOREST RIVER
Brand	ROCKWOOD MINI LITE
Model	2205S
Type	Travel Trailer
Status	New
Stock #	TD467440
Financing Available	✓
Warranty Available	✓
Suspension	Torflex
Leveling	N/A
Exterior Length	23.1 ft.
Dry Weight	5073 lbs.
Sleeping Capacity	2 person(s)
Interior Colour	Sedona-Stone
Exterior Colour	Fiberglass
Slideouts	1

Disclaimer: Product information, pricing and photos are as accurate as possible and are subject to change without notice.

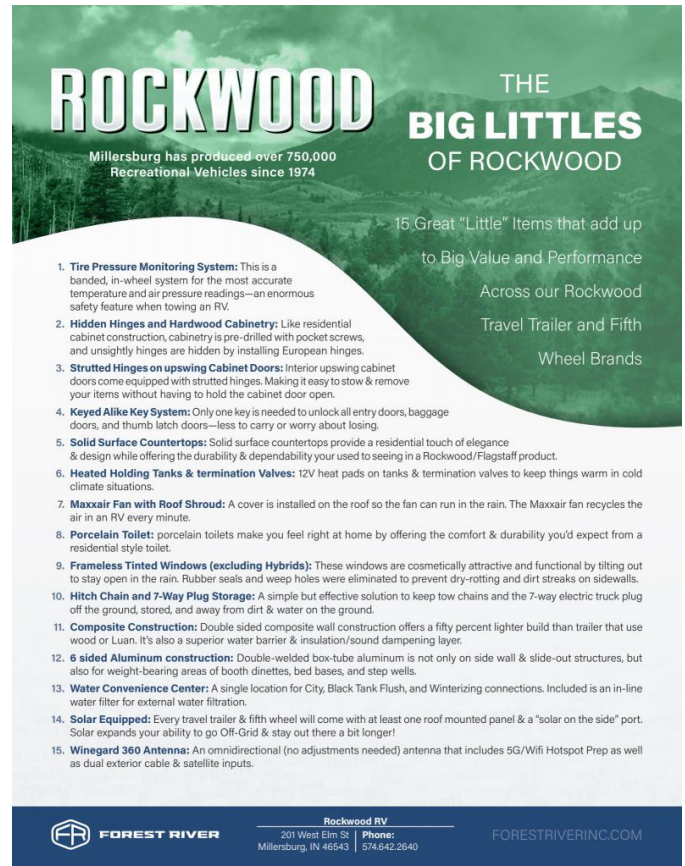
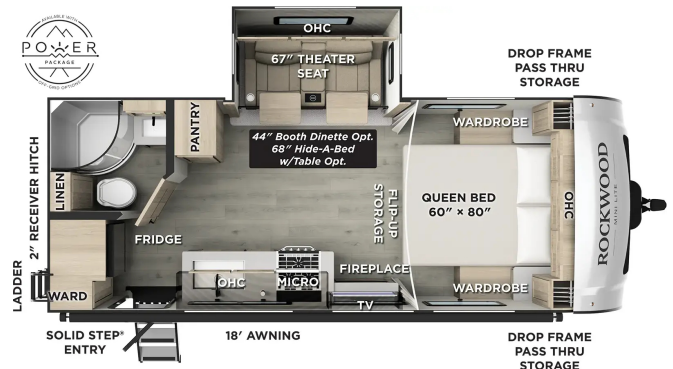
SELLING FEATURES

Specifications and Features:

- Exterior Length: 23 ft 10 in
- Exterior Width: 8 ft
- Exterior Height: 10 ft 11 in
- Dry Weight: 5,073 lbs
- GVWR: 6,794 lbs
- Hitch Weight: 634 lbs
- Fresh Water Capacity: 54 gallons
- Gray Water Capacity: 29 gallons
- Black Water Capacity: 29 gallons
- Sleeps:...

OPTIONS & EQUIPMENT

Additional Options Included:

- Additional 200W Solar Panel
- PSX2 Power Stabilizers

Superior Construction

- Complete Composite Wall Construction
- Fully Laminated Walkable Roof
- 6-Sided Full-Aluminum Frame

- 5/8" Tongue & Groove Plywood Floor
- Aluminum Floor Joists
- Fiberglass Front Cap w/Clear Coat
- Automotive Glass Windshield

Standard Features

- 200W Solar Panel with 1800W Inverter & 30 AMP Charge Controller
- Back-Up Camera Prep
- Maxxair Fan with Cover
- Winegard Air 360+ Prepped for Wi-Fi
- Frameless Windows
- Key-Alike Lock System
- Slam Baggage Doors
- Additional Solar Prep
- Double Battery Box
- Double 30 Lb. LP Tanks

Climate Protection Package

- 12V Thermostat-Controlled Heated Tanks
- Radiant Foil in Front Cap Underbelly and Slides

Great Expectations Package

2 Tone Fiberglass Exterior

- High Gloss Front Cap
- Automotive Front Windshield
- Power Tongue Jack
- Stabilizer Jacks
- Composite Structural Exterior Walls
- Vacuum Laminated Roof
- Aluminum Cage Construction
- Frameless Windows
- Slam Latch Baggage Doors w/Magnetic Catch
- 15 000 BTU A/C
- Enclosed Underbelly w/Thermostatically Controlled Heated Holding Tanks
- Prewire for Backup Camera
- Power Awning
- 200W Solar Panel w/Inverter & Additional Solar Side Port
- AIR 360+ Omnidirectional Antenna w/WiFi Prep
- One Control APP Monitor Panel
- 12V Smart Entertainment TV w/Stereo
- Outside Speakers
- 12V Refrigerator
- Fireplace (Where Available)
- 35K BTU Furnace (20K BTU 2109S)
- Microwave Gas Oven w/Glass Cover
- 6 Gallon Quick Recovery Auto Ignite Gas/Electric Water Heater
- DEXTER Torflex Torsion Axles
- GOODYEAR Endurance Tires w/TPMS Tire Pressure Monitoring System
- Roller Shades
- Solid Entry Step Rail
- MORryde Strut Assist Steps (Strut N/A 2 Step)
- Key Alike Doors
- Undermount Kitchen Sink w/High Rise Faucet
- Solid Surface Kitchen Countertops
- Soft Close Roller Bearing Drawers
- Hidden Hinge Cabinet Doors
- Rear Ladder
- Black Tank Flush
- Water Saver Shower Miser
- Exterior Hot/Cold Water Port
- Water Filter Supplied
- Gas Griddle Prep
- 2" Accessory Hitch
- Spare Tire Carrier & Cover
- Power Awning w/ Adjustable Rain Dump & LED Lighting

Powered by focusRV