



## PIERSON MOTORS

mpierson@piersonmotors.ca 1-519-395-2424

2065 Concession 12, Ripley, ON NOG 2R0

Local 1-519-395-2424 | Fax 1-519-395-4141 | <https://www.piersonmotors.ca/>



### SPECIAL UNIT

## 2026 FOREST RIVER WILDWOOD X-LITE 25ICE

### SPECIFICATIONS

Year	2026
Manufacturer	FOREST RIVER
Brand	WILDWOOD X-LITE
Model	25ICE
Type	Travel Trailer
Status	New
Stock #	P3185
Financing Available	✓
Warranty Available	✓
Suspension	N/A
Leveling	N/A
Exterior Length	29.8 ft.
Dry Weight	6178 lbs.
Sleeping Capacity	6 person(s)
Interior Colour	N/A
Exterior Colour	Aluminum
Slideouts	1

**Disclaimer:** Product information, pricing and photos are as accurate as possible and are subject to change without notice.

### SELLING FEATURES

#### Specifications and Features:

- Exterior Length: 29.83 ft (358 in)
- Exterior Width: 8 ft (96 in)
- Exterior Height: 10.25 ft (123 in)
- Dry Weight: 6,178 lbs
- Gross Vehicle Weight Rating (GVWR): 7,735 lbs
- Hitch Weight: 735 lbs
- Fresh Water Tank Capacity: 40 gallons
- Gray Water Tank Capac...

### OPTIONS & EQUIPMENT

- Platinum Package: Fiberglass Exterior 200W Solar Panel with 30 AMP Controller (Not Available for 25ICE 26ICE)
- Spare Tire & Carrier
- Ducted A/C (171 19 261) \*Standard on Slide Models
- Exterior Camp Kitchen (19 261) \*Standard (24VIEW 240 263 273 28)
- Power Stabilizer Jacks
- 15 000 BTU Ducted A/C in Place of Standard 13.5k
- Outside Shower
- 200W Solar Panel with 30AMP Controller

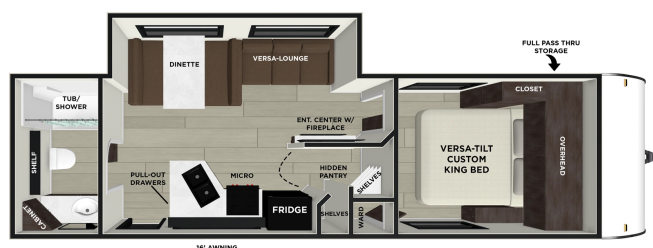

Powered by focusRV