



## WOODY'S RV WORLD RED DEER

webleads@woodysrvreddeer.dsmessage.com 1-800-267-8253

71 Burnt Park Drive, Red Deer, AB T4P 0J7

Local 1-403-346-1130 | Fax 1-403-341-4380 | <https://www.woodysrv.com/>



### 2026 SUNSET PARK RV SUN LITE 16BH

MSRP \$32,980.00

**\$121 Bi-Weekly**

\$0 down @ 7.99% APR for 60/240 months

(\$11,850 C.O.B.) O.A.C.

**Woody's Price \$29,980.00**

#### SPECIFICATIONS

|                     |                    |
|---------------------|--------------------|
| Year                | 2026               |
| Manufacturer        | SUNSET PARK RV     |
| Brand               | SUN LITE           |
| Model               | 16BH               |
| Type                | Travel Trailer     |
| Status              | New                |
| Stock #             | 51220              |
| Financing Available | ✓                  |
| Warranty Available  | Manufacturer       |
| Suspension          | N/A                |
| Leveling            | N/A                |
| Exterior Length     | 16.5 ft.           |
| Dry Weight          | 2580 lbs.          |
| Sleeping Capacity   | 3 person(s)        |
| Interior Colour     | WHITE OAK/GRAPHITE |
| Exterior Colour     | N/A                |
| Slideouts           | N/A                |

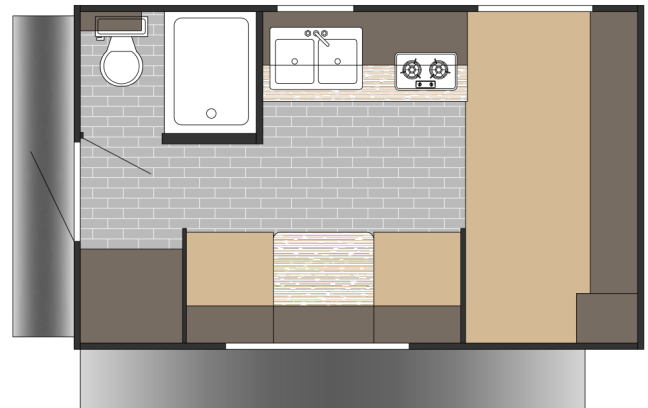

16BH

**Disclaimer:** Product information, pricing and photos are as accurate as possible and are subject to change without notice.

#### OPTIONS & EQUIPMENT

- COMFORT PACKAGE: PORTABLE BLUETOOTH SPEAKER, 12 VOLT CONVERTER, MANUAL TONGUE JACK, STABILIZER JACKS (N/A 109), EZ LUBE AXLES W/ ELECTRIC BRAKES, RADIAL TIRES, SPARE TIRE & CARRIER, ROCK GUARD, OUTSIDE SHOWER, SMOKE DETECTOR, C/O DETECTOR, BATTERY DISCONNECT, CABLE/SATELLITE HOOK-UP, POWER ROOF VENT, TINTED WINDOWS, LED LIGHTS, 6 GALLON DSI GAS WATER HEATER, MICROWAVE, FURNACE, QUICK CONNECT GAS LINE, 100 WATT SOLAR PANEL
- CONFIDENCE PACKAGE: 16" O.C. CONSTRUCTION, ONE PIECE PVC ROOF MEMBRANE, WALKABLE ROOF, CHOICE OF WHITE OR GREY METAL W/ CHOICE OF SECONDARY METAL COLOR, X2 20LB PROPANE TANKS, ELECTRIC AWNING, STD STOVE TOP, SOLID STEP, RANGE HOOD, ROOF MOUNTED A/C, OVERHEAD BUNK (16BH-18RD), PASS THROUGH STORAGE (WHERE AVAILABLE), 10.7 CU 12V REFER STANDARD
- OFF ROAD PACKAGE: 6" LIFT W/ HEAVY DUTY TIRES & BLACK METAL RIMS, LARGE GRAB HANDLE
- 7FT REAR POWER AWNING
- FANTASTIC FAN
- 190 WATTS SOLAR W/CONTROLLER
- 6 GAL WATER HEATER W/ ELECTRIC ELEMENT
- SUNLITE PACKAGE DISCOUNT
- VOLUME DISCOUNT
- LOYALTY DISCOUNT
- DEALER PICK UP

Powered by focusRV