



CONSIGNMENT UNIT

\$72,992.00

2015 ITASCA SUNCRUISER 32H

SPECIFICATIONS

Year	2015
Manufacturer	ITASCA
Brand	SUNCRUISER
Model	32H
Type	Motorhome
Class	A
Fuel Type	Gas
Status	PreOwned
Stock #	E0A13416
Financing Available	✓
Warranty Available	✗
Odometer	56400 mi.
VIN	N/A
Chassis	Ford F-Series Super Duty
Engine	Triton V10 6.8L
Transmission	AUTO
Suspension	N/A
Leveling	N/A
Exterior Length	33.2 ft.
Dry Weight	22000 lbs.
Sleeping Capacity	6 person(s)
Interior Colour	N/A
Exterior Colour	Fiberglass
Slideouts	2

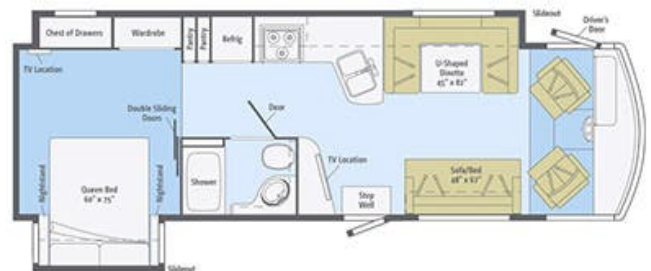

Disclaimer: Product information, pricing and photos are as accurate as possible and are subject to change without notice.

SELLING FEATURES

Specifications and Features:

- Exterior Length: 33.2 ft.
- Exterior Width: 8.46 ft.
- Exterior Height: 12.42 ft.
- Interior Height: 7 ft.
- Wheelbase: 18.33 ft.
- GVWR: 22,000 lbs.
- Fuel Capacity: 80.0 gal.
- Fresh Water Tank Capacity: 78.0 gal.
- Gray Water Tank Capacity: 47.0 gal.
- Black ...

OPTIONS & EQUIPMENT

- Full Body Paint
- GPS Navigation System
- Side View Camera
- Power Roof Vent with Rain Sensor
- Upgraded Leather Sofa/Sleeper
- Fireplace
- Exterior Entertainment Center
- Ceiling Fan
- Security System (Deluxe)
- Slide Out Tray-Full Pass Through

2015 ITASCA SUNCRUISER 32H — CLASS A GAS MOTORHOME

Consignment price: **\$72 999**

Mileage: **56 290 mi** (one-owner non-smoker)

Location: TowTally Camping – **4161 Riverside Place Anderson CA 96007**

SELLER'S NOTE

“Years of fun and adventure! Tis the season—please share!”

HIGHLIGHTS

- Ford F-53 Super Duty chassis • 6.8 L Triton V10 (362 hp / 457 lb-ft)
- 33 ft 2 in overall length with **2 power slide-outs** (full-wall + bedroom)
- **Sleeps 6**: rear queen UltraLeather Rest-Easy sofa convertible dinette
- Cummins Onan 5.5 kW generator • hydraulic leveling jacks
- Two electric awnings • electric entry steps
- Three TVs (2 inside / 1 outside) • exterior entertainment center & shower
- Four-door refrigerator with ice-maker • 3-burner range oven & microwave
- Corian countertops with tile trim • UltraLeather upholstery
- Dual-zone heat & 27 k BTU A/C
- 5 000-lb receiver hitch — tow your boat or flat-towed vehicle

KEY SPECS

- GVWR: 22 000 lb **Fuel**: 80 gal gasoline
- **Fresh / Gray / Black**: 78 / 47 / 43 gal **Propane**: 23 gal (98 lb)
- **Exterior height**: 12 ft 5 in **Interior height**: 7 ft
- **Wheelbase**: 220 in **Awning**: 17 ft power

READY TO SEE IT?

Call or text: **530-241-7848** sales@towtallycamping.com

Powered by focusRV