



**SICARD RV**

sales.leads.focusrv@sicardrv.com 1-800-688-2210  
7526 Regional Road 20, West Lincoln, ON L0R 2A0  
Local 1-905-957-3344 | www.sicardrv.com



**SPECIAL UNIT**

**\$144,990.00**

Originally \$149,990

\$656 Bi-Weekly

## 2026 KEYSTONE MONTANA 3915TB

### SPECIFICATIONS

Year	2026
Manufacturer	KEYSTONE
Brand	MONTANA
Model	3915TB
Type	Fifth Wheel
Status	New
Stock #	23470
Financing Available	✘
Warranty Available	✘
Suspension	N/A
Leveling	N/A
Exterior Length	43.0 ft.
Dry Weight	15180 lbs.
Sleeping Capacity	9 person(s)
Interior Colour	Woodcliff
Exterior Colour	Mystic White
Slideouts	4

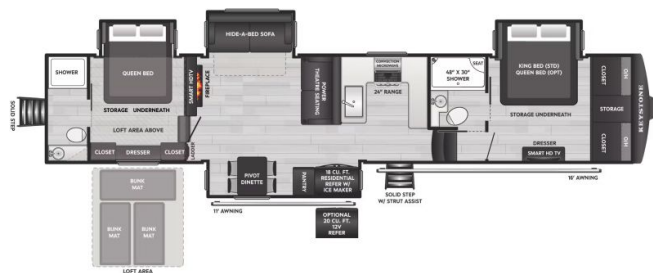

**Disclaimer:** Product information, pricing and photos are as accurate as possible and are subject to change without notice.

### SELLING FEATURES

Introducing the 2026 Montana 3915TB, from Keystone. Embark on the journey of a lifetime with the Montana 3915TB. This fifth wheel sleeps up to 9 people. Inside the Montana 3915TB, you will find a rear loft area providing additional sleeping spaces when required. Included with this Montana 3915TB ...

### OPTIONS & EQUIPMENT

- CANADIAN COMPLIANCE
- MONTANA FOUR SEASON LIVING PACKAGE
- RVIA SEAL - GO CAMPING
- MYSTIC WHITE EXTERIOR
- RESIDENTIAL LIVING PACKAGE
- WOODCLIFF DECOR
- SOLAR FLEX DISCOVER
- REFRIGERATOR - 12V - 20CF
- 6 POINT HYDRAULIC AUTO LEVELING
- TRIPLE A/C PACKAGE

Powered by focusRV