



2025 GULF STREAM VINTAGE CRUISER 19MBS

\$42,280.00

Originally \$56,750.00

SPECIFICATIONS

Year	2025
Manufacturer	GULF STREAM
Brand	VINTAGE CRUISER
Model	19MBS
Type	Travel Trailer
Status	New
Stock #	25GS010
Financing Available	✓
Warranty Available	✓
Suspension	N/A
Leveling	N/A
Exterior Length	23.1 ft.
Dry Weight	3192 lbs.
Sleeping Capacity	4 person(s)
Interior Colour	N/A
Exterior Colour	Fiberglass
Slideouts	N/A

Disclaimer: Product information, pricing and photos are as accurate as possible and are subject to change without notice.

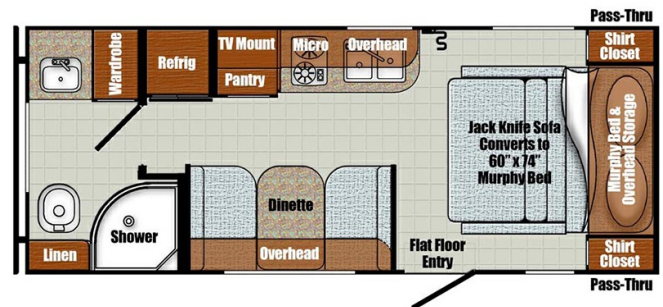

SELLING FEATURES

Specifications and Features:

- Length (ft): 23'1"
- Width (ft): 7'6"
- Height (ft): 10'2"
- Interior Height (ft): 6'11"
- GVWR (lbs): 4420
- Dry Weight (lbs): 3192
- Payload Capacity (lbs): 1228
- Hitch Weight (lbs): 420
- Number Of Fresh Water Holding Tanks: 1
- Total Fresh Water Tank Capacity: 30

OPTIONS & EQUIPMENT

2025 Gulf Stream Vintage Cruiser 19MBS – Where Retro Charm Meets Modern Adventure

Get ready to turn heads at every campground with the 2025 Gulf Stream Vintage Cruiser 19MBS – a true fusion of nostalgic style and modern comfort. With its signature retro design sleek fiberglass sidewalls and bold color schemes this trailer isn't just a camper – it's a statement.

Compact Yet Spacious

Measuring 23'1" in length and just 7'6" wide the 19MBS is the perfect travel companion for those who crave easy towing and effortless maneuverability without sacrificing space. Inside the impressive 6'11" ceiling height creates an open airy feel that's rare in a trailer this size.

Comfortably Sleeps Up to Four

Whether you're a couple chasing adventure or a small family exploring the open road the 19MBS delivers comfort and flexibility. The queen-size Murphy bed folds away to reveal a cozy sofa for daytime lounging while a convertible dinette or sofa bed accommodates overnight guests with ease.

Fully Equipped Gourmet Kitchen

Cook your favorite meals wherever you roam with the three-burner range oven microwave and spacious double-door refrigerator. Plenty of countertop space and overhead storage make this kitchen as functional as it is stylish.

Climate Controlled for All Seasons

Stay comfortable year-round with a powerful 15 000 BTU air conditioner and a 25 000 BTU furnace. From hot summer days to brisk mountain mornings the Vintage Cruiser keeps you at the perfect temperature.

Spacious Rear Bathroom

The full rear bath includes a roomy shower toilet vanity and plenty of storage space — so you never have to compromise on comfort or convenience.

Onboard Utilities and Tank Capacities

- Fresh Water Tank: 21 gallons
- Gray Water Tank: 33 gallons
- Black Water Tank: 33 gallons
- Propane Capacity: 9.4 gallons (two tanks)

With generous tank capacities and efficient systems you're well-equipped for both campground stays and off-grid getaways.

Lightweight Durable Construction

Built on an aluminum frame with fiberglass sidewalls the Vintage Cruiser is as tough as it is stylish. With a dry weight of just 3 192 lbs and a hitch weight of 420 lbs it's towable by many midsize SUVs and light-duty trucks giving you more freedom to explore.

Outdoor Living Made Easy

The power-retractable awning extends with the push of a button providing instant shade and comfort. Whether you're relaxing outside or hosting friends the outdoor space is just as inviting as the interior.

Why Choose the 2025 Vintage Cruiser 19MBS?

This is more than just a travel trailer — it's a throwback to the golden age of camping wrapped in today's top features and technology. Lightweight stylish and full of personality the 19MBS is built for those who want to travel differently.

Now available — come see it for yourself and experience the perfect blend of vintage flair and modern functionality.

Powered by focusRV