



## SPECIAL UNIT

# \$66,900.00

Originally \$69,900

\$326 Bi-Weekly

### 2025 FOREST RIVER SALEM VILLA 40FDEN

#### SPECIFICATIONS

Year	2025
Manufacturer	FOREST RIVER
Brand	SALEM VILLA
Model	40FDEN
Type	Park Model
Status	New
Stock #	034582
Financing Available	✓
Warranty Available	✓
Suspension	N/A
Leveling	Manual
Exterior Length	40.5 ft.
Dry Weight	10279 lbs.
Sleeping Capacity	4 person(s)
Interior Colour	N/A
Exterior Colour	Aluminum
Slideouts	2

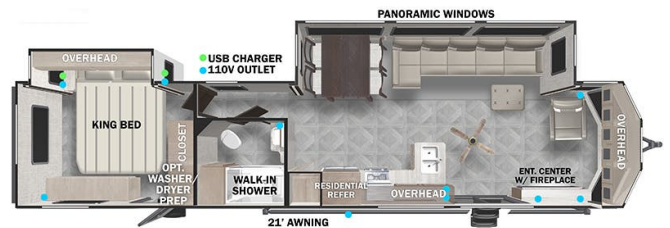

**Disclaimer:** Product information, pricing and photos are as accurate as possible and are subject to change without notice.

#### SELLING FEATURES

Couple's park model with large front windows featuring pullout sofa for your overnight guests!

Features:

- **Best In Class Value Package:** Upgraded Designer Furniture Package, Exterior LED Light Strip Under Awning, Heated & Enclosed Access-Belly (w/ Removable Panels), LED Interior Mushroom Style Bright Lights, Central Vacuum w/ Sweep Attachment, Seamless Countertops (No T-Mold), Modern Cloth Roller Shades w/ AutoStop, Recessed Stove w/ Glass Stove Cover, Stainless Steel Kitchen Appliances, Oversized Residential Microwave, Stainless Steel Dual Basin Undermount Sink, LED Accent Light PKG: Under Cabinets and Over LR Slides, Stainless Steel Roll Up Sink Cover, 30" Built-In Electrical Fireplace (Heater), Serta Mattress, Slide-Out Awning Prep
- Sleeps up to 4 - rear king bed and the sofa that fold out to a bed
- Living space with two sofas, reclining chair, free-standing table with four chairs, and entertainment center with fireplace
- Kitchen includes fridge/freezer, microwave, stove top and range, oven, and double basin sink
- Bathroom includes shower, vanity, and toilet
- Power awning
- Deep cycle marine battery and propane tanks
- Full manufacturer's warranty
- Delivery and setup available to your park!
- Dry weight of 10,279lbs

No hidden fees (freight, PDI, licensing, admin, or battery fee). Simply add the HST! Financing available.

#### OPTIONS & EQUIPMENT

- Pre-delivery Inspection
- Deep Cycle RV Battery
- Propane Tank(s)
- Licensing Completed
- Electrical Adaptor
- 25' Water Hose
- 10' Sewer Hose
- Thorough Walkthrough