



2025 FOREST RIVER ROCKWOOD ULTRA LITE 2619FK

\$45,992.00

Originally \$66,695.60

SPECIFICATIONS

Year	2025
Manufacturer	FOREST RIVER
Brand	ROCKWOOD ULTRA LITE
Model	2619FK
Type	Travel Trailer
Status	New
Stock #	SZ194608
Financing Available	✓
Warranty Available	✓
Suspension	Torflex
Leveling	Automatic
Exterior Length	29.8 ft.
Dry Weight	6834 lbs.
Sleeping Capacity	4 person(s)
Interior Colour	Sedona-Stone
Exterior Colour	FIBERGLASS
Slideouts	2

Disclaimer: Product information, pricing and photos are as accurate as possible and are subject to change without notice.

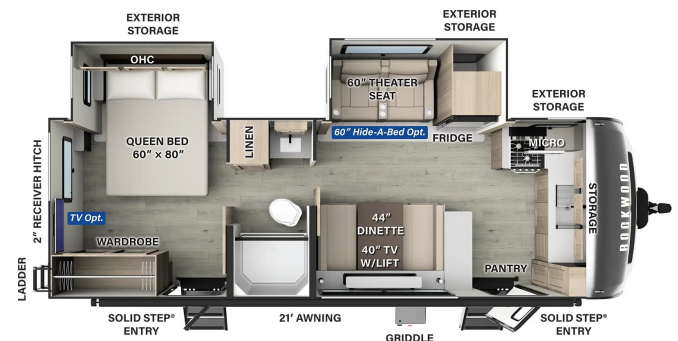

SELLING FEATURES

2025 Forest River Rockwood Ultra Lite 2619FK – Innovative Front Kitchen Travel Trailer with Dual Slides

Introducing the all-new 2025 Forest River Rockwood Ultra Lite 2619FK, a thoughtfully designed travel trailer that combines luxury, functionality, and efficiency. This innovative floorplan fe...

OPTIONS & EQUIPMENT

Day/Night Rollershades

Extra 200W roof solar panel

BAL 53 Leveling

Standard Travel Trailer Package F:

White Fiberglass Exterior High Gloss Fiberglass Cap Azdel Structural Exterior Walls Vacuum Laminated Roof Aluminum Cage Construction Front Windsheild Frameless Windows Slam Latch Baggage Doors w/Magnetic Catch 15 000 BTU A/C Enclosed Underbelly w/Thermostatically Controlled Heated Holding Tanks Prewire for Backup Camera Power Awning 200W Solar Panel w/Inverter & Additional Solar Side Port AIR 360+ Omnidirectional Antenna w/WI-FI Prep One Control APP Monitor Panel Smart TV Bunkroom Smart Entertainment TV 50AMP Service 12V Refrigerator Fireplace (Where Available) 6 Gallon Quick Recovery Auto Ignite Gas/Electric Waterheater DEXTER Torflex Torsion Axles GOODYEAR Endurance Tires w/TPMS Tire Pressure Monitoring System Roller Shades MorRyde Strut Assist Steps Key Alike Doors Undermount Kitchen Sink w/High Rise Faucet Solid Surface Kitchen Countertops Hidden Hinge Cabinet Doors Rear Ladder Black Tank Flush Shower Miser Exterior Hot/Cold Water Port Gas Griddle 2" Accessory Hitch Spare Tire Carrier & Cover

Interior Features:

- Sedonwood Cabinetry
- Screwed & Glued Solid Wood Cabinet Doors & Drawers With Hidden Hinges Metal Drawer Glides & Residential-Style Hardware
- 35K BTU Furnace
- Carbon Monoxide Detector
- Interior 12V USB Outlet
- OneControl Panel with WeRV App Control
- 55 AMP Converter with Charger
- Ceiling LED 12V Interior Lighting
- Quick Recovery Water Heater w/ Interior Gas/Electric Switches

- 50 Amp Service and Digital Dual Thermostat Control
- 15 000 BTU Ducted Air Conditioner
- Night Roller Shade

Living Area Features:

- Deluxe Theater Seating
- 12V Smart Entertainment TV w/Stereo
- Marine Grade Carpet in Slides

Bedroom Features:

- Large Wardrobe or Wardrobe Slide
- Designer Bedding
- Optional Smart Bedroom TV

Construction Features:

- 6 Sided Aluminum Framed (Side Walls End Wall Front Floor & Roof)
- 5/8" Plywood Tongue & Groove Subfloor
- Insulation Factors R-7 Side Wall R-12 Floor & R-14 Ceiling
- Radiant Foil Insulated Underbelly & Slide Out Floors
- Enclosed Underbelly
- Electronically Controlled Heated Holding Tanks
- Radius Roof w/ Interior Vaulted Ceilings
- Vinyl/Rubber Composite Roofing Membrane
- Vacuum Laminated One Piece Roof & Walls
- Aluminum Cage Dinette & Bed Base

Towing Features:

- Rear Observation Camera Prep w/ Molded Mounting Plate
- Easy Lube Axles & Nev-R Adjust Brakes
- Torsion Axle Rubber-Ryde Suspension
- Spare Tire w/ Carrier & Cover
- Power Tongue Jack
- Nitrogen Filled Goodyear Endurance Tires w/ Balancing Beads
- TST Tire Pressure Monitor System w/ Monitor
- 2 5/16" Ball
- Polished Alloy Wheels

Kitchen Features:

- Three Burner High Output Gas 21" Oven w/Flush Mount Glass Top Cover
- Microwave Oven
- Solid Surface Kitchen Countertops
- Designer Kitchen Backsplash
- 12V Refrigerator
- Under mount Single Basin Kitchen Sink w/ Residential-Style Faucet
- Water Filter Supplied

Bathroom Features:

- Shower Miser Water Saving System
- Bathroom Skylight
- Foot Flush Toilets
- Maxxair Ventilation Fan & Cover
- Water Heater By-Pass Kit

Powered by focusRV