

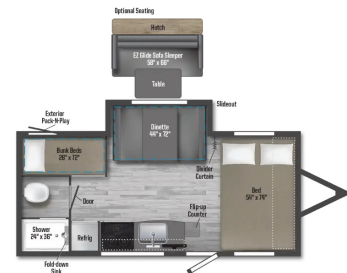

2025 WINNEBAGO MICRO MINNIE 2100BH

SPECIFICATIONS

Year	2025
Manufacturer	WINNEBAGO
Brand	MICRO MINNIE
Model	2100BH
Type	Travel Trailer
Status	New
Stock #	101411
Financing Available	✓
Warranty Available	✓
Suspension	N/A
Leveling	N/A
Exterior Length	20.0 ft.
Dry Weight	4049 lbs.
Sleeping Capacity	5 person(s)
Interior Colour	N/A
Exterior Colour	Fiberglass
Slideouts	1



Disclaimer: Product information, pricing and photos are as accurate as possible and are subject to change without notice.

SELLING FEATURES

Top of the line, lightweight dual axle bunk model with dinette slide!

Features:

- **Adventure Package:** NXG engineered frame, Exterior fiberglass sidewalls w/ Azdel, 13.5K BTU A/C, Microwave convection, 10.3 cubic ft 12V refrigerator, 6 Gallon gas/electric/DSI water heater, Aluminum wheel assemblies, Power awning w/ LED lighting, Power tongue jack, Recessed 3 burner cook top w/ backlit knobs & glass cover, 15" off-road tire/axle lift, Torflex Dexter Axle(s), LED exterior lighting, Heated & enclosed holding tanks, Radiant foil insulation, One-piece TPO roof membrane, Roof mount solar charger prep, Exterior ladder, TPO front cap, 2" Accessory hitch receiver, 7-way plug holder, Porcelain toilet, Roller blackout shades, 14x22 bathroom skylight, larger shower w/ integrated sink
- **Convenience Package:** TPMS prep, Camp side spray port, JBL Aura Cube high performance mechless media center w/ parametric lighting, USB charge ports, TV antenna, JBL premium sound interior & exterior speakers, SMART TV, Rearview camera prep, Wifi prep, Wireless cell phone charger, All-in-one control panel, Side mount camera prep, Inverter prep
- **Versatility Package:** (1) 200-watt solar panel w/ 30AMP charge control monitor & side mount solar prep, 12v holding tank pad heaters w/ interior switch, Power stabilizer jacks
- Sleeps 5- front queen bed, single bunks and a dinette that converts to a bed
- Kitchen includes fridge/freezer, microwave, stovetop with cover
- Bathroom with shower and toilet
- Furnace and ducted A/C
- Spare tire, carrier, and cover
- Power stabilizing jacks
- Includes deep cycle marine battery and propane tanks
- Full manufacturer's warranty
- Dry weight of 4,049lbs

No hidden fees (freight, PDI, licensing, admin, or battery fee). Simply add the HST! Financing available.

OPTIONS & EQUIPMENT

- Pre-delivery Inspection
- Deep Cycle RV Battery
- Propane Tank(s)
- Licensing Completed
- Electrical Adaptor
- 25' Water Hose
- 10' Sewer Hose
- Thorough Walkthrough