



**SPECIAL UNIT**

**\$18,992.00**

Originally \$23,992

**2024 KEYSTONE HIDEOUT SPORT SINGLE AXLE 181BH**

**SPECIFICATIONS**

Year	2024
Manufacturer	KEYSTONE
Brand	HIDEOUT SPORT SINGLE AXLE
Model	181BH
Type	Travel Trailer
Status	New
Stock #	RW244698
Financing Available	✓
Warranty Available	✓
Suspension	N/A
Leveling	N/A
Exterior Length	22.8 ft.
Dry Weight	4515 lbs.
Sleeping Capacity	8 person(s)
Interior Colour	N/A
Exterior Colour	Aluminum
Slideouts	1

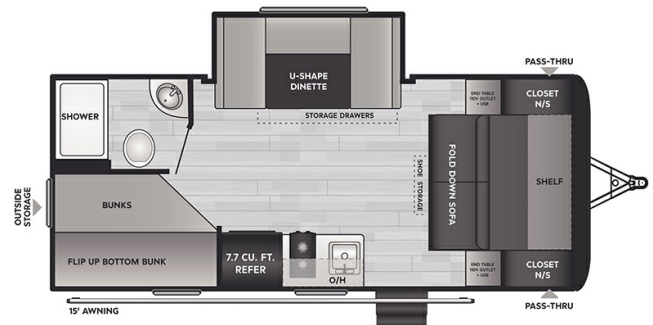

**Disclaimer:** Product information, pricing and photos are as accurate as possible and are subject to change without notice.

**SELLING FEATURES**

**Specifications and Features:**

- Length (ft): 22'9"
- Width (ft): 8'0"
- Height (ft): 10'4"
- GVWR (lbs): 5100
- Dry Weight (lbs): 4515
- Payload Capacity (lbs): 585
- Hitch Weight (lbs): 595
- Number Of Fresh Water Holding Tanks: 1
- Total Fresh Water Tank Capacity (gal): 21
- Number Of Gray W...

**OPTIONS & EQUIPMENT**

Hideout Sport single-axle models offer your customers exceptional build quality in our shortest lightest floorplans. Ranging from 3 000 to 4 300 lbs and all under 23' these single axle models are a great choice for SUB and light duty truck owners that want smaller units without giving up important features like a fully functioning bathroom and furnace. Here are our top 20 reasons why shoppers should choose Hideout Sport over other brands.

**3 YEAR STRUCTURAL WARRANTY:** Built better backed longer for your peace-of-mind

**8' WIDE CONSTRUCTION:** Larger dinettes bigger bathrooms more storage

**20 000 BTU FURNACE:** Don't rely on a fireplace for extended season comfort

**TANKLESS WATER HEATER:** Longer showers await with endless instant hot water

**LARGE 8 000 BTU AIR CONDITIONER:** Optional 15.5K Roof mounted Air Conditioner available

**BATHROOM SINKS:** We agree ... it's weird to not have a bathroom sink

**FULLY INSULATED DURA-FLOOR CONSTRUCTION:** 2" floor joists directly above I-Beam 12"- 16" apart 5/8"

**DYNA-SPAN FLOOR DECKING WITH 25 YEAR WARRANTY:** Seamless 8' x 24' moisture resistant panel glued & secured 2"

WALL CONSTRUCTION ON 16" CENTERS: Thicker and better insulated than the competition

FULLY FRAMED SIDEWALL CUT-OUTS: Superior strength and leak resistance

SOLARFLEX READY CAPABILITIES STANDARD: Upgrade to the optional SolarFlex 220 Protect

SOLID WOOD DOORS AND DRAWERS: No vinyl or paper wrapped doors or drawers

WOOD CORE CABINET CONSTRUCTION: Wood core cabinets (not MDF) screwed together (not stapled)

TIRE LINC TIRE PRESSURE MONITORING SYSTEM: Prepped for after-market TPMS installation

LARGER WINDOWS BIGGER CABINETS: Expanding your enjoyment and convenience

SHOWER SURROUND AND SKYLIGHT: Upgraded shower experience

RESILIENT VINYL FLOORING IN PLACE OF CARPET: Pet friendly easy to clean less odors and fumes

CHASSIS SPECIFIC FRAME: Keystone designed specifically for each floorplan

SUPERFLEX ROOFING MEMBRANE: Reduced maintenance with a LIFETIME warranty

MY KEYSTONE OWNERS APP: Instant access to digital owner's manual how-to videos & more

Powered by focusRV