



## GREAT ESCAPE RV

justin@greatescapervcanada.com 1-888-716-4542  
RR42 - 24265 Richmond St. N, LONDON, ON N5X 4B2  
Local 1-519-227-4700 | Fax 1-519-227-4788 | www.greatescapervcanada.com



## 2018 FOREST RIVER Hemisphere GLX 337BAR

**\$49,995.00**

**\$336 Bi-Weekly**

### SPECIFICATIONS

Year	2018
Manufacturer	FOREST RIVER
Brand	Hemisphere GLX
Model	337BAR
Type	Fifth Wheel
Status	PreOwned
Stock #	U721
Financing Available	✓
Warranty Available	✓
Suspension	N/A
Leveling	Electric
Exterior Length	39.6 ft.
Dry Weight	10069 lbs.
Sleeping Capacity	4 person(s)
Interior Colour	Brown
Exterior Colour	Fiberglass
Slideouts	3

**Disclaimer:** Product information, pricing and photos are as accurate as possible and are subject to change without notice.

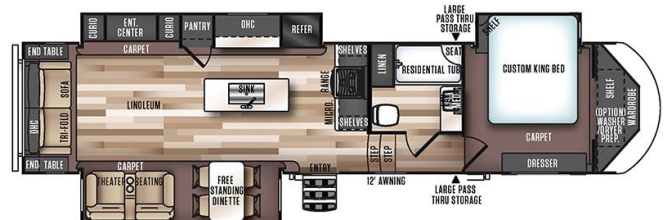

### SELLING FEATURES

From luxurious fabrics to rich wood tones, the Salem Hemisphere is truly in a class of its own. Plus, you'll enjoy better gas mileage and a smoother ride with the wind-resistant design of the Hemisphere. The 337BAR is a Beautiful couples' unit, with a free-standing dinette, theater seating, tri-f...

### OPTIONS & EQUIPMENT

Awning 12'	Fridge with 2 doors	Heating	1 Air Conditioning Unit(s) (Ducted) - Size: 13.5	Back Flush	AC/DC Converter	Solid Surface Counter Tops
Enclosed Underbelly	Free Standing Table	Fully Furnished	LPG Detector	Microwave	Monitor Panel	
Power Bath Vents	1 Sky Light(s)	Smoke Detector	Spare with Carrier	Toilet Facilities	Gas/Elec Water Heater 16G	
Power Awning	Power Stabilizer jacks	Rear Camera Prep	Solar Panel Prep			