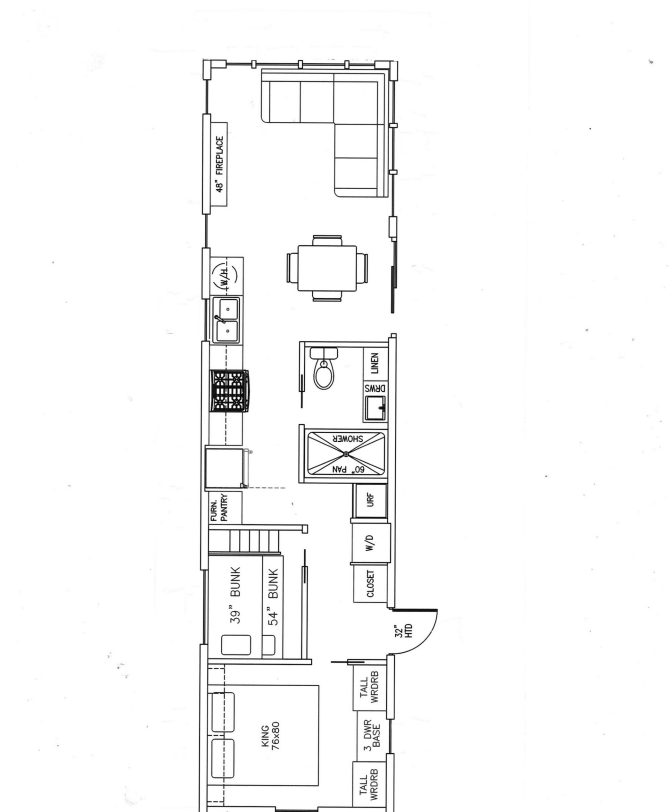

2023 ELEVATION PARK MODEL 5-116CA**\$169,900.00****\$796 Bi-Weekly****SPECIFICATIONS**

Year	2023
Manufacturer	ELEVATION
Brand	PARK MODEL
Model	5-116CA
Type	Park Model
Status	New
Stock #	683171
Financing Available	✓
Warranty Available	✓
Suspension	N/A
Leveling	N/A
Exterior Length	48.0 ft.
Dry Weight	14000 lbs.
Sleeping Capacity	7 person(s)
Interior Colour	N/A
Exterior Colour	N/A
Slideouts	N/A

Disclaimer: Product information, pricing and photos are as accurate as possible and are subject to change without notice.

**SELLING FEATURES**

Modern park model with spacious living area and two bedrooms!

- Sleeps up to 6- rear queen bedroom and separate bunkroom with single over double bunks
- Kitchen includes residential fridge and stove, microwave, lots of cabinets and large sink
- Dining table with four chairs
- Spacious living room complete with large sectional
- Entertainment space with TV and fireplace and ceiling fan
- Bathroom with stand up shower, vanity and toilet
- Washer/Dryer prep
- Two door entrance and entrance way closets
- Manufacturers warranty
- Delivery and set up available to your park!

Construction:

- Architectural Shingles - 40 Year Warranty
- 7/16\"/>

- Fixed Side Overhangs
- Vinyl Siding w/50 Year Warranty
- Fiberglass Insulation: R-19 Sidewalls, R-22 Floors, &
- R-33 Roof
- Weather resistant Thermo-Sheathing
- Metal Strapping Connecting Sidewalls to Floor
- 2×6 Sidewall Studs 16" o.c.
- 10" Steel I-Beam Frame w/ 4 axles
- 2×6 Floor joists 16" o.c.
- Floor ductwork w/ perimeter registers
- 5/8" Decking w/ water sealant
- 6' Vinyl Patio Door
- Vinyl Thermopane Windows w/ Argon
- Shed Dormers Entire Length
- Removable CSA Hitch
- Metal Hurricane Straps

Standard Features:

- 50 Amp Electrical cord (36')
- Central Air
- 30-gallon electric W/H w/ lighted switch
- 18' GE Refrigerator w/ top freezer – Black
- 30" GE Gas Range – Black
- 30" Over the Range Microwave – Black
- Stainless Steel Deep Kitchen Sink
- Pull down spray kitchen faucet
- Table with four chairs
- Black or Brushed Nickel hardware
- LED lights under Kitchen Cabinets
- Custom high-end residential cabinetry
- Baseboard Moulding throughout
- Toe Kicks in Cabinetry
- Raised Panel Interior Doors
- Cordless 2" Blinds
- LED can lights throughout
- Ceiling Fan w/Light – LR (BRM non loft only)
- 60 x 80 Standard King premium mattress
- 2 Night Stands in Bedroom
- Master BRM hanging wardrobe w/ drawer bank
- Fiberglass Tub or Shower w/ fiberglass headwell
- Single Lever Bathroom Faucet
- Stainless Steel Bathroom Sink
- Residential House Toilet
- Power bathroom vent
- TV Jack in LR, BRM & Loft
- USB outlets in Kitchen, Bedroom, & Loft
- Porch Lights by Each Door
- Exterior 110 GFI outlet
- Fire Extinguisher
- Smoke & CO2 Detector

Upgraded Options:

- 56,000 BTU furnace
- Washer/Dryer prep
- Lift up Bed Box
- Galvanized Metal Underbelly
- Cabinet Crown molding and Soft Close on Doors and Drawers
- Elongated Toilet
- Upgraded shower and shower head
- 50" Smart TV

No hidden fees (freight, PDI, licencing, admin, or battery fee). Simply add the HST! Financing available.

Powered by focusRV