



## RECREATION WORLD RV

sales@recworldrv.com 1-807-767-3455  
2320 Dawson Rd, Thunder Bay, ON P7G 2G2  
Local 1-807-767-3455 | Fax 1-807-767-4803 | <http://recworldrv.com/>

### 2018 KEYSTONE RV SPRINGDALE 260LE

#### SPECIFICATIONS

|                     |                |
|---------------------|----------------|
| Year                | 2018           |
| Manufacturer        | KEYSTONE RV    |
| Brand               | SPRINGDALE     |
| Model               | 260LE          |
| Type                | Travel Trailer |
| Status              | PreOwned       |
| Stock #             | UTV663         |
| Financing Available | ✖              |
| Warranty Available  | ✖              |
| Suspension          | N/A            |
| Leveling            | N/A            |
| Exterior Length     | 26.0 ft.       |
| Dry Weight          | 5220 lbs.      |
| Sleeping Capacity   | N/A person(s)  |
| Interior Colour     | N/A            |
| Exterior Colour     | N/A            |
| Slideouts           | N/A            |

**Disclaimer:** Product information, pricing and photos are as accurate as possible and are subject to change without notice.

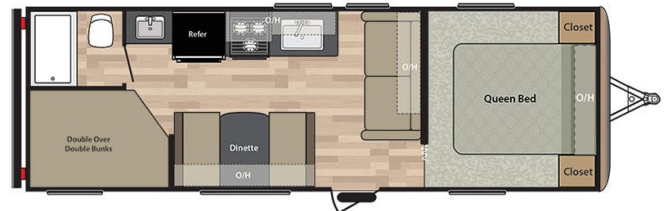

#### SELLING FEATURES

- QUEEN BED
- DOUBLE OVER DOUBLE BUNKS
- DINETTE W BENCH SEATS
- REAR BATH LAYOUT

Powered by RVHotline Canada & SynergyPro Solutions