



NIAGARA TRAILERS

rv@niagaratrailers.com 1-800-348-9653

Box 153 1224 York Road, St Davids, ON L0S 1P0

Local 1-905-262-4518 | Fax 1-905-262-4697 | www.niagaratrailers.com

SPECIAL UNIT

2022 K-Z INC. CONNECT SE 221RBSE

SPECIFICATIONS

| | |
|---------------------|----------------|
| Year | 2022 |
| Manufacturer | K-Z INC. |
| Brand | CONNECT SE |
| Model | 221RBSE |
| Type | Travel Trailer |
| Status | New |
| Stock # | SP1202 |
| Financing Available | ✓ |
| Warranty Available | ✓ |
| Suspension | N/A |
| Leveling | N/A |
| Exterior Length | 22.0 ft. |
| Dry Weight | 5322 lbs. |
| Sleeping Capacity | 4 person(s) |
| Interior Colour | ASHWOOD |
| Exterior Colour | N/A |
| Slideouts | 1 |

Disclaimer: Product information, pricing and photos are as accurate as possible and are subject to change without notice.

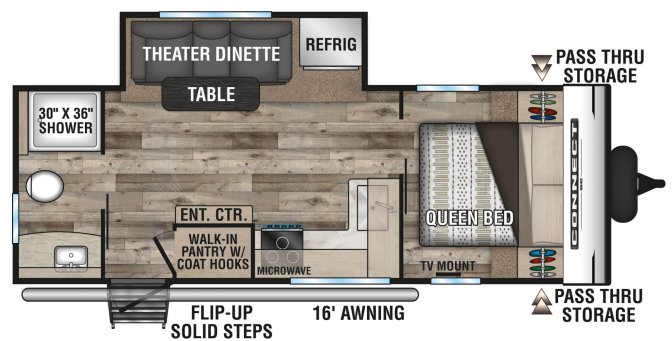

SELLING FEATURES

LIGHTWEIGHT TRAVEL TRAILERS. Getting into the action just got easier! The all-new Connect SE is available in several diverse floorplans. Slideouts make SE feel spacious and welcoming. Modeled after Connect but lighter and lower-priced, the SE is nicely outfitted, including: Drop-in cooktop w/oven...

OPTIONS & EQUIPMENT

INCLUDED OPTIONS:

- 8CF Gas/Elec Refrigerator
- Goodyear Tires

Also Includes:

- Freight
- Pre-delivery Inspection
- 10' Sewer Hose with adapter
- Deep Cycle RV Battery
- Propane Tank(s)
- Electrical Adapter
- 25' Water Hose
- RVIA/QAI/Canadian Standard

Powered by RVHotline Canada & SynergyPro Solutions