

**SPECIAL UNIT**

**\$30,800.00**

Originally \$37,300

**\$58 Weekly**

**2021 GULFSTREAM NORTHERN EXPRESS 21TBD**

**SPECIFICATIONS**

|                     |                  |
|---------------------|------------------|
| Year                | 2021             |
| Manufacturer        | GULFSTREAM       |
| Brand               | NORTHERN EXPRESS |
| Model               | 21TBD            |
| Type                | Travel Trailer   |
| Status              | New              |
| Stock #             | M7053543         |
| Financing Available | ✓                |
| Warranty Available  | ✓                |
| Suspension          | N/A              |
| Leveling            | Manual           |
| Exterior Length     | 22.6 ft.         |
| Dry Weight          | 3655 lbs.        |
| Sleeping Capacity   | 3 person(s)      |
| Interior Colour     | N/A              |
| Exterior Colour     | White Azdel      |
| Slideouts           | 1                |

**Disclaimer:** Product information, pricing and photos are as accurate as possible and are subject to change without notice.

**SELLING FEATURES**

Convertible twin beds to King bed. Roomy interior.

**Interior**

- Solid Wood Stiles
- 'Cipollino Bianco' Laminated Countertop
- Wood Cabinet Doors
- 'Royal Silk' Wall Vinyl
- Accent Walls in Slide Out

**Safety & Miscellaneous**

- Triple Entry Step
- Safety Chains
- Break-Away ...

**OPTIONS & EQUIPMENT**

**Ultralite World Package (Required/Included)**

- Molded Fiberglass Cap w/LED Light Strips
- Fold-Away Grab Handle
- Solid Surface Countertop w/Sink Covers & Glass Top Range Cover
- Radial Tires w/Aluminum Rims
- Upgraded Exterior

**Other Popular Options**

- Interior & Exterior TV Mounting Brackets
- Rear Bumper Mount Gas Grill
- Electric Stabilizer Jacks
- Power Tongue Jack in place of Manual Tongue Jack
- 19" 32" or 40" HDMI LED TV
- 15 000 BTU Roof Air Conditioner
- Raised Panel Refrigerator Door Inserts
- 8 cu ft. Refrigerator (in place of 6 cu. ft.)
- Bar Stools
- (2) Recliners in place of Barrel Chairs
- Electric Fireplace

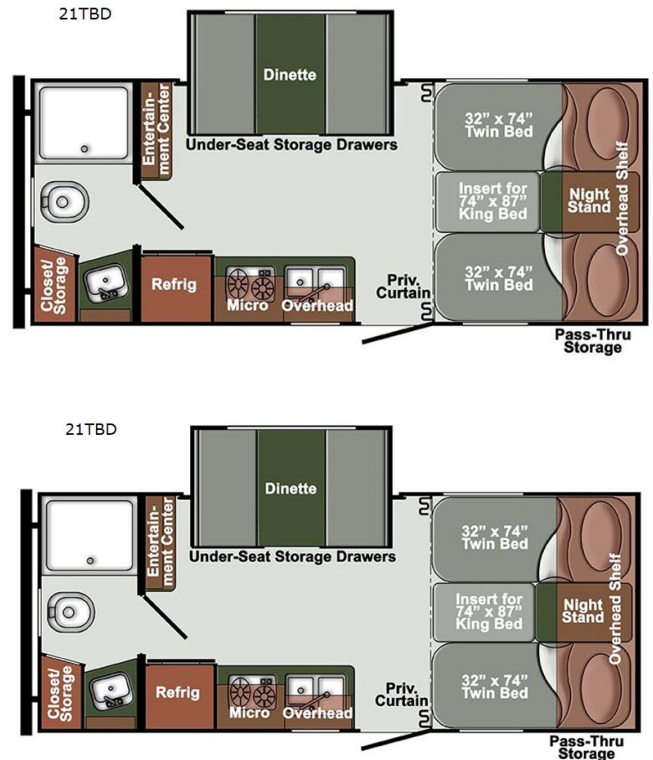

- Deluxe Front Overhead Cap
- Residential Trifold Sofa in place of Jackknife Sofa
- Freestanding Table w/4 Chairs

## Popular SVT Options

- Interior and Exterior TV Mounting Brackets
- Rear Bumper Mount Gas Grill
- Power Hitch Jack in place of Manual Jack
- Spare Tire with Carrier
- Outside Spray Port
- Fold-Away Grab Handle
- 13 500 BTU Roof Air Conditioner
- Microwave Oven (Required)
- Premium Foam Mattress
- 19" and/or 32" HDMI LED TV
- Home Theater Stereo with Blue Tooth
- Glass Shower Door (19FMB)
- Night Shades in place of Mini-Blinds
- Murphy Bed (19FMB)
- Range Cover
- 3-Burner Gas Range & Oven (18RBD 19FMB 22UDL)
- Black Tank Flush
- 6 Gal Gas/Electric Water Heater
- Aluminum Rims with Radial Tires (14": 18RBD 22UDL all SVT90's; 15": 19FMB)
- Soft-Trac Shower Door (all SVT90's)
- Solid Step® Entry Step

Powered by RVHotline Canada & SynergyPro Solutions