

SPECIAL UNIT

\$30,800.00

Originally \$37,300

\$58 Weekly

2021 GULFSTREAM NORTHERN EXPRESS 21TBD

SPECIFICATIONS

| | |
|---------------------|------------------|
| Year | 2021 |
| Manufacturer | GULFSTREAM |
| Brand | NORTHERN EXPRESS |
| Model | 21TBD |
| Type | Travel Trailer |
| Status | New |
| Stock # | M7053543 |
| Financing Available | ✓ |
| Warranty Available | ✓ |
| Suspension | N/A |
| Leveling | Manual |
| Exterior Length | 22.6 ft. |
| Dry Weight | 3655 lbs. |
| Sleeping Capacity | 3 person(s) |
| Interior Colour | N/A |
| Exterior Colour | White Azdel |
| Slideouts | 1 |

Disclaimer: Product information, pricing and photos are as accurate as possible and are subject to change without notice.

SELLING FEATURES

Convertible twin beds to King bed. Roomy interior.

Interior

- Solid Wood Stiles
- 'Cipollino Bianco' Laminated Countertop
- Wood Cabinet Doors
- 'Royal Silk' Wall Vinyl
- Accent Walls in Slide Out

Safety & Miscellaneous

- Triple Entry Step
- Safety Chains
- Break-Away ...

OPTIONS & EQUIPMENT

Ultralite World Package (Required/Included)

- Molded Fiberglass Cap w/LED Light Strips
- Fold-Away Grab Handle
- Solid Surface Countertop w/Sink Covers & Glass Top Range Cover
- Radial Tires w/Aluminum Rims
- Upgraded Exterior

Other Popular Options

- Interior & Exterior TV Mounting Brackets
- Rear Bumper Mount Gas Grill
- Electric Stabilizer Jacks
- Power Tongue Jack in place of Manual Tongue Jack
- 19" 32" or 40" HDMI LED TV
- 15 000 BTU Roof Air Conditioner
- Raised Panel Refrigerator Door Inserts
- 8 cu ft. Refrigerator (in place of 6 cu. ft.)
- Bar Stools
- (2) Recliners in place of Barrel Chairs
- Electric Fireplace

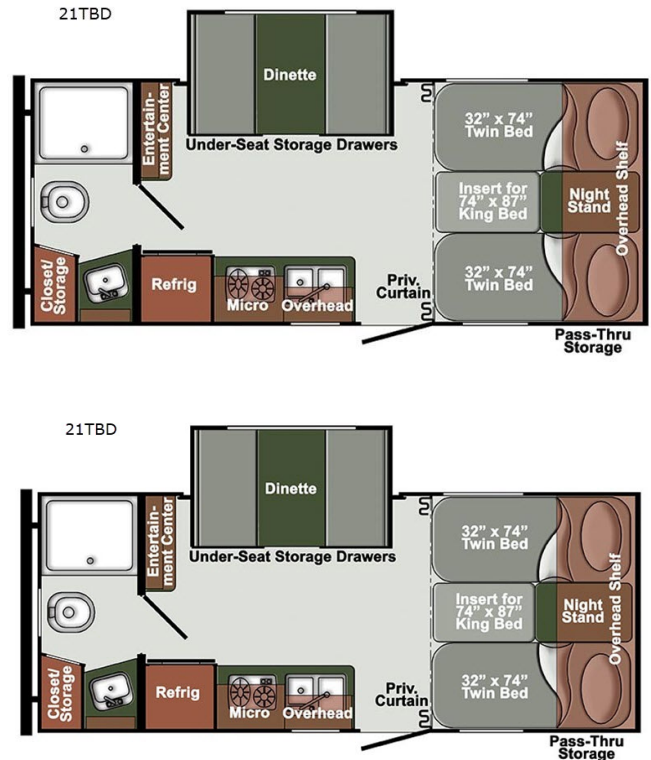

- Deluxe Front Overhead Cap
- Residential Trifold Sofa in place of Jackknife Sofa
- Freestanding Table w/4 Chairs

Popular SVT Options

- Interior and Exterior TV Mounting Brackets
- Rear Bumper Mount Gas Grill
- Power Hitch Jack in place of Manual Jack
- Spare Tire with Carrier
- Outside Spray Port
- Fold-Away Grab Handle
- 13 500 BTU Roof Air Conditioner
- Microwave Oven (Required)
- Premium Foam Mattress
- 19" and/or 32" HDMI LED TV
- Home Theater Stereo with Blue Tooth
- Glass Shower Door (19FMB)
- Night Shades in place of Mini-Blinds
- Murphy Bed (19FMB)
- Range Cover
- 3-Burner Gas Range & Oven (18RBD 19FMB 22UDL)
- Black Tank Flush
- 6 Gal Gas/Electric Water Heater
- Aluminum Rims with Radial Tires (14": 18RBD 22UDL all SVT90's; 15": 19FMB)
- Soft-Trac Shower Door (all SVT90's)
- Solid Step® Entry Step

Powered by focusRV