

SPECIAL UNIT

2022 COACHMEN CLIPPER 182DBU

SPECIFICATIONS

Year	2022
Manufacturer	COACHMEN
Brand	CLIPPER
Model	182DBU
Type	Travel Trailer
Status	New
Stock #	12642
Financing Available	✓
Warranty Available	✓
Suspension	Springs
Leveling	Manual
Exterior Length	22.3 ft.
Dry Weight	3845 lbs.
Sleeping Capacity	4 person(s)
Interior Colour	N/A
Exterior Colour	Aluminum
Slideouts	N/A

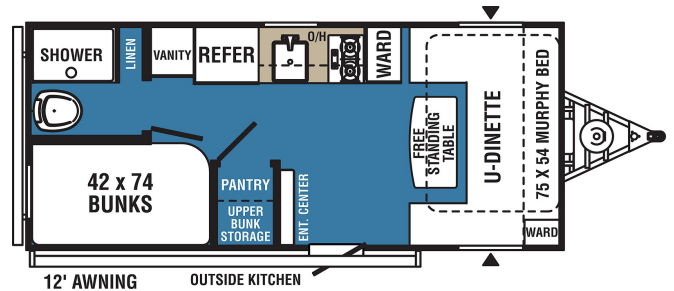

Disclaimer: Product information, pricing and photos are as accurate as possible and are subject to change without notice.

SELLING FEATURES

Looking for a small tandem axle trailer? The Clipper 182DBU is available on our lot and this trailer only weighs 3845lbs and sleeps 4-6 people! This nicely laid out floor plan gives you a huge u-dinette for the day and easy to convert Murphy bed at night. The bunks offer storage, the washroom has...

OPTIONS & EQUIPMENT

Awning	Heating	Air Conditioning Unit(s)	Battery Tray	AC/DC Converter	Fully Furnished	Stabilizer Jacks
LPG Detector	Microwave	Monitor Panel	Power Bath Vents	Sky Light(s)	Smoke Detector	
Spare with Carrier	Toilet Facilities	TV Antenna	Outdoor Kitchen	Outside Speakers	Power Tongue Jack	

Powered by focusRV