



SPECIAL UNIT

\$19,900.00

Originally \$21,900

\$102 Bi-Weekly

2020 COACHMEN CLIPPER 19TB

SPECIFICATIONS

Year	2020
Manufacturer	COACHMEN
Brand	CLIPPER
Model	19TB
Type	Hybrid
Status	PreOwned
Stock #	8579
Financing Available	✓
Warranty Available	✓
Suspension	N/A
Leveling	N/A
Exterior Length	19.0 ft.
Dry Weight	4048 lbs.
Sleeping Capacity	8 person(s)
Interior Colour	N/A
Exterior Colour	Aluminum
Slideouts	N/A

Disclaimer: Product information, pricing and photos are as accurate as possible and are subject to change without notice.

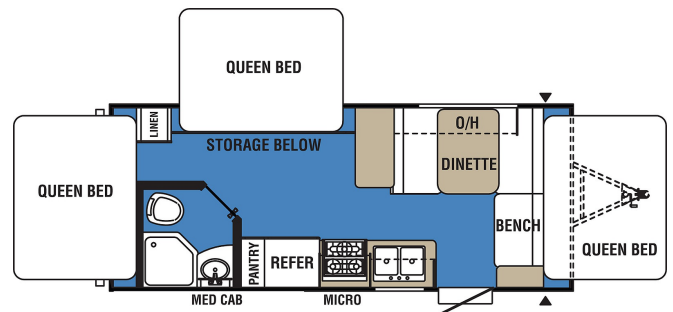

SELLING FEATURES

THE LONGSTANDING TRADITION OF COACHMEN VALUE IN RECREATIONAL VEHICLES CONTINUES WITH THIS BRAND NEW LAYOUT IN THE CLIPPER 7' 6" WIDE TRAVEL TRAILER HYBRID.

DESIGNED TO GIVE A LITTLE EXTRA ROOM, THEY ARE 6 INCHES WIDER AND 4 FEET LONGER THAN THE 17 FOOT MODELS. FULLY EQUIPPED WITH ALL THE CREA...

Powered by focusRV