



## GREAT ESCAPE RV

justin@greatescapervcanada.com 1-888-716-4542

RR42 - 24265 Richmond St. N, LONDON, ON N5X 4B2

Local 1-519-227-4700 | Fax 1-519-227-4788 | www.greatescapervcanada.com

### SPECIAL UNIT

## 2020 K-Z INC. Connect 332BHK

### SPECIFICATIONS

Year	2020
Manufacturer	K-Z INC.
Brand	Connect
Model	332BHK
Type	Travel Trailer
Status	New
Stock #	N834
Financing Available	✓
Warranty Available	✓
Suspension	N/A
Leveling	Manual
Exterior Length	37.6 ft.
Dry Weight	7780 lbs.
Sleeping Capacity	9 person(s)
Interior Colour	Coffee
Exterior Colour	Fibreglass
Slideouts	2

**Disclaimer:** Product information, pricing and photos are as accurate as possible and are subject to change without notice.

### SELLING FEATURES

Stylish, adventurous and beautiful inside & out! Affordable yet well-appointed, Connect offers creative floorplans. You'll love the gorgeous décor, entertainment features and high-end fiberglass exterior. Connect is packed with standard features typically available only as options such as; Wide D...

### OPTIONS & EQUIPMENT

Awning 18'	Aluminum Wheels	Fridge with 2 doors	Heating	1 Air Conditioning Unit(s) (Ducted) - Size: 15	000	Back Flush
Battery Tray	AC/DC Converter	Solid Surface Counter Tops	Day Night Shades	Dual Wheels	Enclosed Underbelly	
Fireplace	Fully Furnished	Hide A Bed	Island Bed	Stabilizer Jacks	LPG Detector	
Microwave	Convection Oven	Monitor Panel	Outside Shower	Power Bath Vents	1 Sky Light(s)	
Smoke Detector	Spare with Carrier	Toilet Facilities	1 Televisions	Gas/Elec Water Heater 6	Outdoor Camp Kitchen	
Power Awning	Rear Camera Prep	Solar Panel Prep				

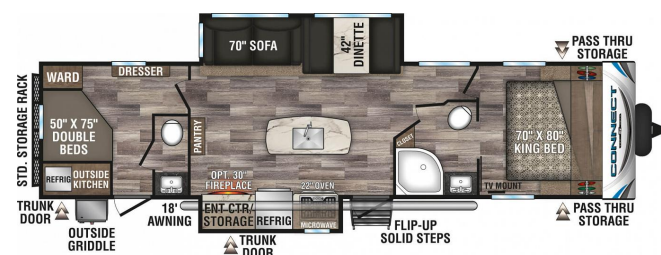

Powered by RVHotline Canada & SynergyPro Solutions