

2020 KEYSTONE AVALANCHE 320RS (couples)

SPECIFICATIONS

Year	2020
Manufacturer	KEYSTONE
Brand	AVALANCHE
Model	320RS (couples)
Type	Fifth Wheel
Status	New
Stock #	N760006s
Financing Available	✓
Warranty Available	✓
Suspension	Springs
Leveling	Automatic
Exterior Length	36.2 ft.
Dry Weight	11460 lbs.
Sleeping Capacity	4 person(s)
Interior Colour	FOREST FLOOR
Exterior Colour	Gel Coat
Slideouts	3

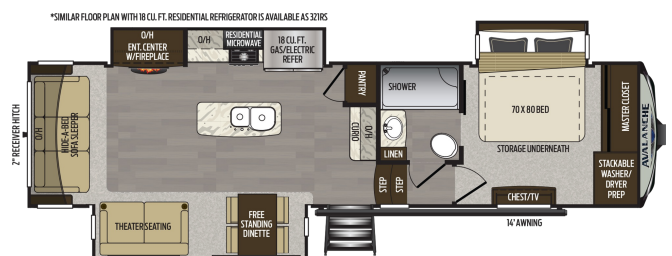

Disclaimer: Product information, pricing and photos are as accurate as possible and are subject to change without notice.

SELLING FEATURES

THIS KEYSTONE AVALANCHE IS A LUXURY 100" WIDE-BODY FIFTH WHEEL COLD WEATHER RATED TO -4 F = -20 CELSIUS.

FEATURES INCLUDE 6 POINT HYDRAULIC AUTO-LEVELLING, 18 CU FT GAS/ELECTRIC FRIDGE, DUAL AIR CONDITIONERS, 50" LED TV, 40" DESIGNER FIREPLACE, KING SIZE BED, KEYSTONE'S 3 YEAR STRUCTURAL WAR...

OPTIONS & EQUIPMENT

Awning 14'	Aluminum Wheels	2 Air Conditioning Unit(s)	Back Flush	Battery Tray	AC/DC Converter	Dual Wheels
Enclosed Underbelly	Fantastic Fan	Fireplace	Free Standing Table	Fully Furnished	Hide A Bed	
LPG Detector	Microwave	Monitor Panel	Outside Shower	Power Air Vents	Power Bath Vents	
Smoke Detector	Spare with Carrier	Toilet Facilities	Trailer Hitch	2 50 & 32" Televisions	TV Antenna	
18 Cu/Ft 2 Door Fridge	35k BTU Furnace	50 AMP Service	6 Pt Hydraulic Auto Level	AM/FM/DVD Bluetooth Stere	Backup Camera Prepared	
Control Trailer Remotely	Frameless Tinted Windows	G-Range Tires	King Size Bed	LED Ceiling Lights	Roller Blinds	
Solar Panel Prep.	Solid Surface Counter Top	Theater Seating	USB Charging Stations	Wash & Dryer Prep		

Powered by RVHotline Canada & SynergyPro Solutions