



## MOBILIFE RV CENTRE

rvsales@mobiliferv.ca 1-866-653-5886

4166 King St E, Kitchener, ON N2P 2G5

Local 1-519-653-5788 | Fax 1-519-653-5885 | <https://www.mobiliferv.ca/>

### 2019 COACHMEN CLIPPER 17BHS

**\$22,500.00**

Originally \$25,263.00

**\$99 Bi-Weekly**

#### SPECIFICATIONS

Year	2019
Manufacturer	COACHMEN
Brand	CLIPPER
Model	17BHS
Type	Travel Trailer
Status	New
Stock #	7610
Financing Available	✓
Warranty Available	✓
Suspension	N/A
Leveling	N/A
Exterior Length	17.0 ft.
Dry Weight	3217 lbs.
Sleeping Capacity	6 person(s)
Interior Colour	N/A
Exterior Colour	Aluminum
Slideouts	1

**Disclaimer:** Product information, pricing and photos are as accurate as possible and are subject to change without notice.

#### SELLING FEATURES

THE LONGSTANDING TRADITION OF COACHMEN VALUE IN RECREATIONAL VEHICLES CONTINUES WITH THE CLIPPER TRAVEL TRAILER.

DESIGNED WITH TODAY'S SMALLER, FUEL EFFICIENT TOW VEHICLES IN MIND, THE CLIPPER TRAVEL TRAILERS WEIGH UNDER 3000LBS LBS. FULLY EQUIPPED WITH ALL THE CREATURE COMFORTS OF LARGER MORE...

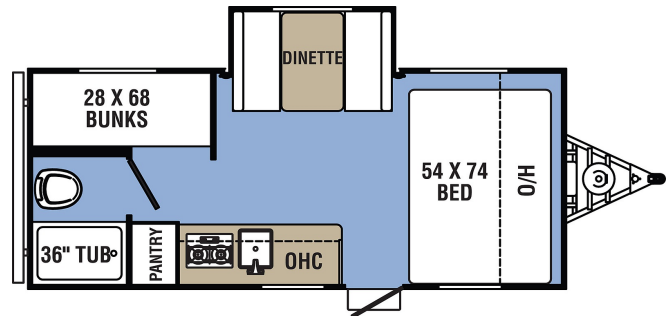

Powered by focusRV