



## GREAT ESCAPE RV

justin@greatescapervcanada.com 1-888-716-4542

RR42 - 24265 Richmond St. N, LONDON, ON N5X 4B2

Local 1-519-227-4700 | Fax 1-519-227-4788 | www.greatescapervcanada.com

### CLEARANCE UNIT

**\$32,995.00**

Originally \$49,595.00

**\$145 Bi-Weekly**

## 2019 FOREST RIVER HEMISPHERE 269RL

### SPECIFICATIONS

Year	2019
Manufacturer	FOREST RIVER
Brand	HEMISPHERE
Model	269RL
Type	Travel Trailer
Status	New
Stock #	N661
Financing Available	✓
Warranty Available	✓
Suspension	N/A
Leveling	N/A
Exterior Length	33.3 ft.
Dry Weight	6120 lbs.
Sleeping Capacity	4 person(s)
Interior Colour	JAGGER INTERIOR DECOR
Exterior Colour	Fibreglass
Slideouts	1

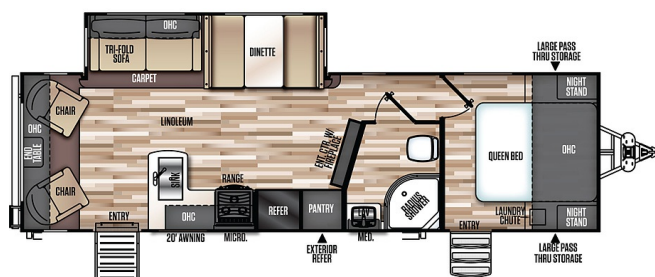

**Disclaimer:** Product information, pricing and photos are as accurate as possible and are subject to change without notice.

### SELLING FEATURES

Rear living design, spacious couples trailer with theater seating and open floor plan. Large panoramic windows allowing optimal natural light inside. This model has been upgraded to include table and chairs and theatre recliner seats, fireplace, Bluetooth media Centre, LCD TV with remote and stai...

### OPTIONS & EQUIPMENT

Awning 20'	Aluminum Wheels	Fridge with 2 doors	Heating	1 Air Conditioning Unit(s)	Back Flush	Battery Tray
Solid Surface Counter Tops	Dual Wheels	Enclosed Underbelly	Extra Door	Fireplace	Free Standing Table	
Fully Furnished	Hide A Bed	Inverter	Island Bed	LPG Detector	Microwave	
Monitor Panel	1 Sky Light(s)	Smoke Detector	Spare with Carrier	Toilet Facilities	1 Televisions	
TV Antenna	Gas/Elec Water Heater	Power Awning	Power Stabilizer jacks	Rear Camera Prep	Solar Panel Prep	

Powered by RVHotline Canada & SynergyPro Solutions