



NIAGARA TRAILERS

rving@niagaratrailers.com 1-800-348-9653
Box 153 1224 York Road, St Davids, ON L0S 1P0
Local 1-905-262-4518 | Fax 1-905-262-4697 | www.niagaratrailers.com

SPECIAL UNIT

2018 K-Z INC. SIDEWINDER 3914TK

SPECIFICATIONS

Year	2018
Manufacturer	K-Z INC.
Brand	SIDEWINDER
Model	3914TK
Type	Toy Hauler
Status	New
Stock #	DU272
Financing Available	✓
Warranty Available	✓
Suspension	N/A
Leveling	N/A
Exterior Length	39.0 ft.
Dry Weight	13660 lbs.
Sleeping Capacity	N/A person(s)
Interior Colour	N/A
Exterior Colour	N/A
Slideouts	N/A

\$89,900.00

Originally \$86,900

\$309 Bi-Weekly

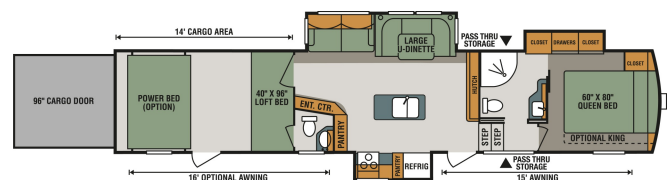

Disclaimer: Product information, pricing and photos are as accurate as possible and are subject to change without notice.

SELLING FEATURES

Construction Features

- 101" Wide-Body Construction
- Extra-Reinforced, Heavy Duty, High-Gloss Front Cap
- Radius Aerodynamic Front Cap (provides better turning radius & increased fuel economy)
- 2" x 3" Fully Welded Aluminum Floor Joists
- 2" x 2" Fully Welded Aluminum Sidewall Framing
- Lam...

OPTIONS & EQUIPMENT

Included Options: 2 Year Warranty

EZ CAMPING PACKAGE

- LP Quick Connect
- Power Awning w/LED Lights
- Keyed A-like Baggage Doors
- Roof Mounted Solar Prep
- Rear Camera Prep
- Motion Sensor Lights (Basement/Bath)
- 30" OTR Microwave
- LED Lighted Exterior
- Speakers
- Electronics Package (Soundbar DVD Player_
- G-Rated Tires
- Climate Control Package
- LED Lighted Crown Moulding in Kitchen Overhead Cabinets
- Decorative Slide out Ceiling Feature w/ Built in LED Lights
- 12v/USB Charging Station.

Other Options:

- Electric 32" Wideview Fireplace
- All Weather Insulation Package
- 12 cuft RV Refrigerator
- Upgraded Gel Foam Mattress
- 6 Point Electric Leveling
- Onan Marquis Gold 5.5KW Gas Generator
- 2nd 15K A/C
- Solid Surface Matching Sink Covers

- 2nd Power Awning w/LED Lights
- HappiJac Elec Bed & Rollover Sofas w/Table
- Ramp Door Patio Rails
- Roto Flex Pinbox Upgrade
- "Off the Grid" Solar Package

Also Includes:

- Freight
- Pre-delivery Inspection
- 10' Sewer Hose with adapter
- Deep Cycle RV Battery
- Propane Tank(s)
- Electrical Adapter
- 25' Water Hose
- RVIA/QAI/Canadian Standard

Powered by focusRV