



## NIAGARA TRAILERS

rvring@niagaratrailers.com 1-800-348-9653  
Box 153 1224 York Road, St Davids, ON L0S 1P0  
Local 1-905-262-4518 | Fax 1-905-262-4697 | www.niagaratrailers.com

## 2018 FOREST RIVER ROCKWOOD SIGNATURE ULTRA LITE 8335BSS

**\$51,900.00**

**\$179 Bi-Weekly**

### SPECIFICATIONS

Year	2018
Manufacturer	FOREST RIVER
Brand	ROCKWOOD SIGNATURE ULTRA LITE
Model	8335BSS
Type	Travel Trailer
Status	New
Stock #	FR525
Financing Available	✓
Warranty Available	✓
Suspension	N/A
Leveling	N/A
Exterior Length	33.0 ft.
Dry Weight	8036 lbs.
Sleeping Capacity	5 person(s)
Interior Colour	GRAPHITE
Exterior Colour	Fibreglass
Slideouts	2

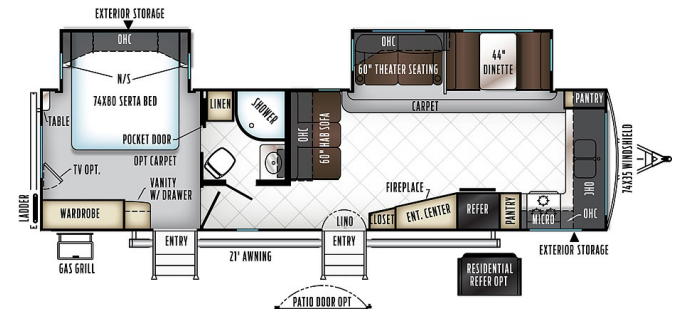

**Disclaimer:** Product information, pricing and photos are as accurate as possible and are subject to change without notice.

### SELLING FEATURES

#### STANDARD PACKAGES INCLUDE:

- Fiberglass Exterior w/ High Gloss Finish
- Aluminum Bed and Dinette Base
- 6 Sided Aluminum Cage Construction
- Vacuum Laminated 1 Piece Roof and Walls
- Tinted Bonded Frameless Windows
- Power Awning w/ Adjustable Rain Dump and LED Light Strip
- Enclosed Underbel...

### OPTIONS & EQUIPMENT

#### INCLUDED OPTIONS

- Maple (w/ Solid Maple Glaze Finished Cabinet Doors) Interior
- Painted auto Front Cap w/ Windshield
- High Gloss GelCoat Exterior
- Aluminum Sofa & Dinette base
- Real Wood Deck
- 1 pc Roof & Walls
- Enclosed Underbelly
- Thermo Controlled HTD Holding Tanks
- 4 Frame Mounted Stab. Jacks
- Power Awning with LED Lights
- Alloy Wheels
- Nitro Filled Radial Tires
- Multi Zone Stereo w/ DVD/CD/AM/FM/BT
- O/S Speakers
- Touch Button/Bluetooth Control Panel
- 13.5 BTU Ducted Roof A/C
- Undermount Stainless Steel Kitchen Sink with High-Rise Faucet
- Recessed CookTop & Oven w/ Flush mount cover
- Hidden Hinge Cabinet Doors
- Self Closing Roller Bearing Drawers
- Microwave Oven
- Ex.Large Double Door 2 way Refer.
- Serta Innerspring Mattress
- Quick Recovery Auto Ignition Gas/Elec Water Heater
- Black Tank Flush
- Spare Tire w/Carrier
- WIFI Ranger
- WIFI Booster
- Champagne Exterior with Color Keyed Roof.

OTHER INCLUDED OPTIONS:

- 4.0 Leveling System
- Wood Look Floor
- 9cuft Refer
- Raised Panel Refer Fronts
- LED Bedroom TV
- Free Standing Dinning Table & Chairs w/ Vista Windows
- Fireplace
- Extra Maxxair Vent Fan & Cover.

Also Includes:

- Freight
- Pre-delivery Inspection
- 10' Sewer Hose with adapter
- Deep Cycle RV Battery
- Propane Tank(s)
- Electrical Adapter
- 25' Water Hose
- RVIA/QAI/Canadian Standard

Powered by focusRV