



NIAGARA TRAILERS

rv@niagaratrailers.com 1-800-348-9653
Box 153 1224 York Road, St Davids, ON L0S 1P0
Local 1-905-262-4518 | Fax 1-905-262-4697 | www.niagaratrailers.com

SPECIAL UNIT

2018 STARCRAFT AUTUMN RIDGE 339BHTS

SPECIFICATIONS

Year	2018
Manufacturer	STARCRAFT
Brand	AUTUMN RIDGE
Model	339BHTS
Type	Travel Trailer
Status	New
Stock #	SC1876
Financing Available	✓
Warranty Available	✓
Suspension	N/A
Leveling	N/A
Exterior Length	33.0 ft.
Dry Weight	8814 lbs.
Sleeping Capacity	10 person(s)
Interior Colour	GRAPHITE
Exterior Colour	Aluminum
Slideouts	3

Disclaimer: Product information, pricing and photos are as accurate as possible and are subject to change without notice.

SELLING FEATURES

Standard Construction Features

Magnum Roof System

Walk-On Decking

Fiberglass Roof Insulation

Screwed-Stile Hardwood Cabinetry

5/8" Tongue and groove main floor decking

I-Class Cambered structural steel I-beam frame

Ducted A/C

One-Piece Seamless rubber roof material

OPTIONS & EQUIPMENT

Options:

- Premium Value Package
- 3-Burner stove/oven with glass cover
- Backsplash
- Ducted A/C
- Electric tongue jack
- EZ store detachable cord
- Folding grab handle
- Porcelain foot flush toilet
- Roof ladder
- Sink covers
- Solar Prep

\$40,900.00

Originally \$37,900

\$142 Bi-Weekly

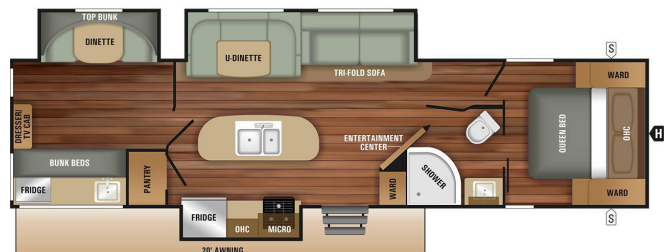

- Spare tire with carrier
- Storage doors under dinette
- Television
- Wireless camera prep
- Customer Convenience Package
 - 12V USB outlet
 - 30 lb. LP gas bottles with cover
 - 8 cu. ft. refrigerator
 - Aluminum rims
 - Bath skylight
 - Bathroom power vent
 - CD/DVD/Bluetooth
 - Docking station with outside sprayer
 - Electric awning with LED light
 - Black front diamond plate
 - Gas/electric water heater
 - Microwave
 - Mirrored wardrobe doors
 - Seamless countertops
 - Tri-fold sofa
 - Tub surround
 - Water heater bypass

Also Includes:

- Freight
- Pre-delivery Inspection
- 10' Sewer Hose with adapter
- Deep Cycle RV Battery
- Propane Tank(s)
- Electrical Adapter
- 25' Water Hose
- RVIA/QAI/Canadian Standard

Powered by focusRV